



Bosch Nexxt® 800 Series Washer

Models / Modèle / Modelo:
WFMC8400UC, WFMC8401UC



BOSCH

Invented for life

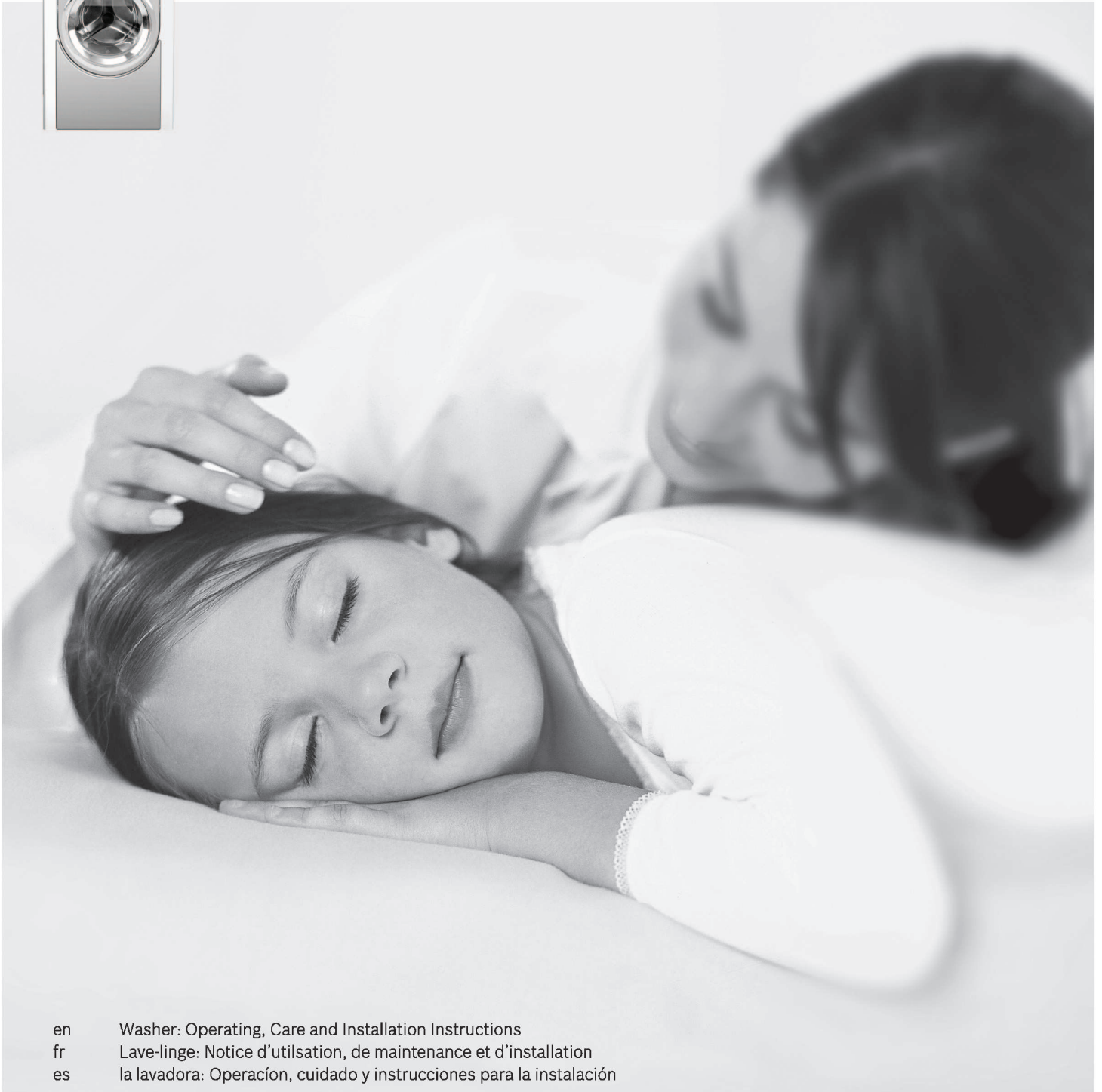

en Washer: Operating, Care and Installation Instructions
fr Lave-linge: Notice d'utilisation, de maintenance et d'installation
es la lavadora: Operación, cuidado y instrucciones para la instalación

Features and Benefits of Your New Washer

SENSOTRONIC® Technology

The Bosch **SENSOTRONIC®** technology optimizes the wash process at every stage of the cycle by sensing load size, water level and temperature needs for superior results. Digital sensors care for all fabrics including wool, mohair and silk. This machine virtually operates at the touch of a button.

Exclusive Hinge and Gasket System

A reinforced hinge and a new, revolutionary gasket design keep the door shut. They also seal in the heat, allowing your laundry to reach the optimum temperature, which eliminates even the toughest stains.

3-Part Detergent Dispenser

A 3-part dispenser automatically distributes the appropriate amounts of detergent, bleach and softener at exactly the right times. And, working together with our unique suds sensor, you can be sure your clothing is rinsed completely clean.

XXTRASANITARY™ Cycle

With this innovative cycle, a thermostat-controlled, intelligent sensor heats up the water to 170° F and maintains the temperature for exactly 3 minutes. After killing 99.9% of most common household bacteria, the water temperature is reduced to a gentler 150° F to prevent clothing breakdown. The clothes are thoroughly cleaned and sanitized with no damage to fibers.

KIDSCARE™ Cycle

The littlest people in the house usually account for the toughest stains. This cycle heats the wash water up to 150° F to remove even the most stubborn stains with ease.

Archie Paddles

As your wash gently tumbles, Archie paddles cascade water from high above, rinsing away suds and giving your laundry a complete, even clean. An inclined drum works with them to ensure not a single shirt goes unturned.

Stainless Steel Drum

The **Nexxt** washer drum has hundreds of smooth double punched holes, which allow your garments to gently tumble completely snag-free.

Internal Water Heater

An Internal Heating Element heats the water to up to 170° F while a Digital Temperature Sensor continually monitors the water temperature. Bosch **Nexxt®** washers deliver the most efficient and accurate water heating method for each selected fabric type.

AQUAGUARD™ Cycle

This wash cycle is engineered to work with water-proof ski apparel, rain gear and other breathable outerwear. Simply fill your water-proofing product into the dispenser chamber, select the **AQUAGUARD™** program and renew the water-proof layer of your garment.

Quiet Performance

Bosch laundry appliances use brushless motors, suspended pump systems and special sound-deadening material to keep them exceptionally quiet while in operation. Which means they can be installed virtually anywhere in the home without causing a disturbance.

SYNCRO™ Technology

Manage your washer and dryer times with the **SYNCRO™** Technology Operation Logic. The **Nexxt®** Dryers coordinate with the spin speed of the washer, based upon the fabric setting and water temperature of your wash load. Therefore, your wash pile won't stack up as you wait for your dryer to finish its cycle.

Table of Contents

Definitions	4
IMPORTANT SAFETY INSTRUCTIONS	4
GROUNDING INSTRUCTIONS	5
INSTALLATION INSTRUCTION	6
Introduction	6
Information concerning waste disposal	6
Intended use	6
Environmental Protection / Conservation Issues	6
Factory-supplied equipment	6
Dimensions	7
Installation area	7
Removing the transport bolts	7
Water connection	8
Hose and cable lengths	10
Electrical connection	10
Leveling procedure	11
Transport, such as when moving out	11
OPERATING INSTRUCTION	12
Your new washer	12
Panel	13
Summary of Instructions	14
Before Using For the First Time	15
Using For the First Time	15
Setting the time	15
Selecting the Language	15
First washing cycle (without laundry)	15
Preparing the laundry	16
Sorting the laundry	16
Degrees of soiling	16
Loading the laundry	17
Laundry Detergents and Additives	17
Dispensing the correct amount of detergent	17
Filling laundry detergent and/or additives	17
Decolorizing	17
Programs and Functions	18
Basic programs	18
Special programs	18
Display Field	19
Option buttons	19
Indicator light above the "Start/Pause" button	19
Special features	19
Washing with Standard Settings	20
Washing with Individual Settings	20
Quick Overview	21
Spin Speed	22
Program finished at	22
Washing Mode	22
Pre-Soak	23
Child lock	24
During Washing	25
Re-selecting a program	25
Add a garment / Interrupting the program	25
Canceling the active program	25
After Washing	26
User Maintenance Instructions	27
Cleaning and Care	27
Cleaning the appliance housing and control panel	27
Cleaning the drum	27
Cleaning the detergent dispenser	27
Cleaning water inlet strainers	27
Descaling the washing machine	28
Troubleshooting of Minor Faults	29
Customer Service	32
STATEMENT OF LIMITED PRODUCT WARRANTY	33
STATEMENT OF WARRANTIES FOR BOSCH CLOTHES WASHERS	35
Exclusions	35
Program Selection Table	112

Congratulations!

The new washing machine you just purchased is a modern, high quality domestic appliance.

This modern washing machine cleans your laundry using the most sophisticated washing processes to obtain superior cleaning results.

Excellent engineering and reliability reduces operating costs significantly.

An easy operation philosophy, a variety of customized washing programs and a solid touch and feel makes this appliance a user-friendly assistant in your household.

It offers the following standard features:

- Low noise level for washing and spinning.
- High door with pull-lock (magnetic door lock).
- Door opening 16 inches (41 cm), quality sturdy hinge, opening angle -180°.
- Drum capacity 20 lbs (9 kg) for regular cotton.

Each washing machine which leaves our factory has undergone a thorough performance test and is in full working condition. The appliance may contain residual water due to the testing procedures. If you have any questions concerning installation of the washing machine, our customer service will be happy to advise you.

Further information and a selection of our products can be found on our Web site: www.boschappliances.com

Please read and follow these operating and installation instructions along with all other information enclosed with the washing machine.

These operating and installation instructions describe various models. Differences are indicated in the appropriate places.

The illustrations may show different details than your washer.

Definitions

WARNING

WARNING – This indicates that death or serious injuries may occur as a result of non-observance of this warning.

CAUTION

CAUTION– This indicates that injuries may occur as a result of non-observance of this warning.

ATTENTION

ATTENTION – This indicates that damage may occur as a result of non-observance of this warning.

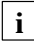
 This symbol is used to draw the user's attention to important matters.

IMPORTANT SAFETY INSTRUCTIONS

WARNING

To reduce the risk of fire, electric shock, serious injury or death when using your washing machine, follow basic precautions, including the following:

1. BOSCH washers are provided with an Operating, Care and Installation Instructions Manual. Read and understand all instructions before using the washing machine.
2. Do not wash articles that have been previously cleaned, washed, soaked, or spotted with gasoline, dry cleaning solvents, other flammable or explosive substances as they give off vapors that could ignite or explode.
3. Do not add gasoline, dry cleaning solvents, or other flammable or explosive substances to the wash water. These substances give off vapors that could ignite or explode.
4. Under certain conditions hydrogen gas may be produced in a hot water system that has not been

used for 2 weeks or more.
HYDROGEN GAS IS EXPLOSIVE.
If the hot water system has not been used for this length of time, turn on all hot water faucets and let the water flow out of each faucet for several minutes before using the washing machine. This will release any accumulated hydrogen gas. As the gas is flammable, do not smoke or use an open flame while carrying out this procedure.

5. Before the appliance is removed from service or discarded, remove the door and the power cord/plug.
6. Do not reach into the appliance if the wash drum is moving.
7. Do not install or store this appliance where it will be exposed to the weather.
8. Do not tamper with the controls.
9. Do not repair or replace any part of the appliance or attempt any service unless specifically recommended in the user maintenance instructions or in published user repair instructions

that you understand and have the skills to carry out.

10. Always unplug the washing machine from the power supply before attempting any service. Disconnect the power cord by grasping the plug, not the cord.
11. To reduce the risk of fire, clothes, cleaning rags, mop heads and the like which have been soiled with any flammable substance, such as vegetable oil, cooking oil, petroleum based oils or distillates, waxes, fats, etc., must be kept away from any source of ignition, including a clothes dryer. These items may contain flammable substances which, even after washing, may smoke or catch fire.
12. Do not machine wash fiberglass materials (such as curtains and window coverings that use fiberglass materials). Small particles may remain in the washing machine and stick to fabrics in subsequent wash loads causing skin irritation.

13. When children become old enough to operate the appliance, it is the legal responsibility of the parents or legal guardians to ensure that they are instructed in safe practices by qualified persons.
14. Do not allow children to play on or with the appliance. Close supervision of children is necessary when the appliance is used near children.
15. Keep pets away from the washing machine.
16. Do not insert/pull out the power plug with wet hands.
17. Do not touch the door if washing at high temperatures.
18. Use caution when draining hot water.
19. Do not climb onto the washing machine and/or lean on the open door.
20. Do not sit or stand on the top of the washing machine.
21. To reduce the risk of fire or electrical shock, DO NOT use an extension cord or an adapter to connect the washing machine to the power supply.
22. The washing machine must only be used for its intended purpose.
23. Always follow the fabric care instructions recommended by the clothing manufacturer.
24. Do not use the washing machine if it has a worn power cord or loose plug. If this is the case, contact an authorized service agent.
25. Make sure that all water connections to the washing machine have shut-off valve(s) that are readily accessible. Close the washing machine water shut-off valve(s) at the end of each wash day.
26. Check the fill hose connections on a regular basis to ensure that they are tight and not leaking.
27. Always read and follow the instructions of the manufacturer of the detergent(s), cleaning aid(s), fabric softener(s) and static eliminator(s) which you are using. Heed all warnings and precautions.
28. Store all laundry chemicals and aids in a cool dry place according to the manufacturers' instructions.
29. To reduce the risk of poisoning or chemical burns, keep all cleaning products out of the reach of children.
30. Do not operate the washing machine if any guards, panels and/or fasteners except transport fixing bolts have been removed.
31. Do not operate the washing machine if parts are missing or broken.
32. Do not bypass any safety devices.
33. To avoid floor damage and mold growth, do not let spills or splashes cause standing water around or under the appliance.
34. Do not operate this washing machine until you are sure that:
 - a. the washing machine has been installed according to the INSTALLATION INSTRUCTIONS.
 - b. all water, drain, power and grounding connections are in compliance with all local regulations and/or other applicable regulations and requirements.
35. Failure to install, maintain and/or operate the washing machine according to the manufacturer's instructions may result in injury and/or damage.
36. Removing any panel, including the round service panel in the front can expose sharp edges and points, electrical connections and hot surfaces.
37. To avoid damage to the door, do not push against the door when moving the unit. Precautions should be taken to avoid damage to the floor.
38. The water connections should be made and tested before electrical power is applied to the machine.

Notes:

- A. The IMPORTANT SAFE-GUARDS and WARNINGS indicated in this manual do not cover all possible conditions which may occur. Common sense, caution and care must be exercised when installing, maintaining or operating the washing machine.
- B. Always contact your dealer, distributor, service agent or the manufacturer about any problems or conditions that you do not understand.

GROUNDING INSTRUCTIONS

This appliance must be grounded. In the event of a malfunction or breakdown, grounding will reduce the risk of electric shock by providing a path of least resistance for the electric current. This appliance is equipped with a cord that has an equipment-grounding conductor and a grounding plug. The plug must be plugged into an appropriate outlet that is properly installed and grounded in accordance with all local codes and ordinances.

WARNING

Improper connection of the equipment grounding conductor can result in electric shock. Connect to an individual branch circuit. Check with a qualified electrician or serviceman if you are in doubt as to whether the washer is properly grounded. DO NOT modify the plug provided with the appliance – if it will not fit the outlet have a proper outlet installed by a qualified electrician.

KEEP THESE INSTRUCTIONS FOR FUTURE REFERENCE.

In case of change of ownership, manual should be conveyed with the washer.

SAVE THESE INSTRUCTIONS

INSTALLATION INSTRUCTION

Introduction



CAUTION

TO AVOID RISK OF INJURY
The washing machine is heavy. Lift with caution.

Be sure to observe all listed warnings and cautions.

ATTENTION

Frozen hoses can tear/burst. Do not install the washing machine outdoors or in an area exposed to freezing conditions.

These installation instructions are intended for use by qualified installers. In addition to these instructions, if installing the washing machine:

- In the United States comply with the National Electric Code, ANSI/NFPA70 – latest edition/State and municipal and/or local regulations.
- In Canada comply with the Canadian Electric Code C22.1 – latest edition/Provincial and Municipal and/or local regulations.

If the washing machine is located in a room which will be exposed to temperatures below freezing, or if it is located in a cabin that is being shut down for the winter, any residual water in the pump or water inlet hose(s) **must** be drained.

Take care not to damage the washing machine. Do not hold on to protruding parts (e.g. door) when lifting.

In addition to the safety information listed here, the local water and electricity supplier may have special requirements.

If in doubt, have the appliance connected by an authorized technician.

Information concerning waste disposal

Disposing of the packaging

The shipping package has protected your new appliance on its way to your home. All packaging materials are non-polluting and recyclable. Please contribute to a better environment by disposing of packaging materials in an environmentally friendly manner.

Please ask your dealer or local authority about the best means of disposal.



WARNING



Keep children away from shipping carton and packaging components. Danger of suffocation from plastic foil and folding cartons.

Disposing of your old appliance

Old appliances are not worthless rubbish! Valuable raw materials can be reclaimed from environmentally friendly recycling.



WARNING



If appliance is no longer usable, pull out main plug, cut off power cord and discard.

To prevent children from locking themselves in the appliance, disable the door lock or remove the door.

Intended Use

Your washing machine is intended:

- For domestic use only.
- For washing machine washable fabrics in washing water.
- For operation using cold and hot (140 °F/60 °C) tap water and conventional additives that are suitable for use in residential washing machines.

Environmental Protection / Conservation Issues

Your washing machine uses water, energy and detergent efficiently, thereby protecting the environment and reducing your household costs.

To use your washing machine in an efficient and non polluting manner:

- Avoid using too much detergent.
- Use detergent bearing HE symbol for high efficiency and front loading washers.
- Add detergent according to the degree of soiling, amount of laundry and water hardness, and follow the detergent manufacturer's instructions.

Factory-supplied Equipment

There is a packet of accessory parts supplied with your washer. Check that all the accessory parts supplied for your model are there. If any parts are missing contact your dealer immediately.

The drum contains:

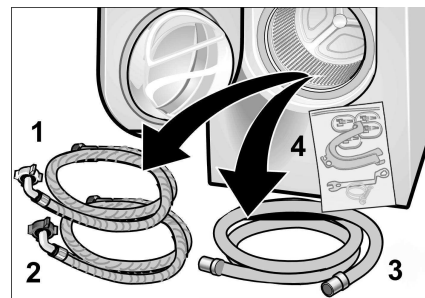

1. Water supply hose for cold water (blue marking).
2. Water supply hose for hot water (red marking).
3. Water drain hose.
4. Accessory parts bag (see below)

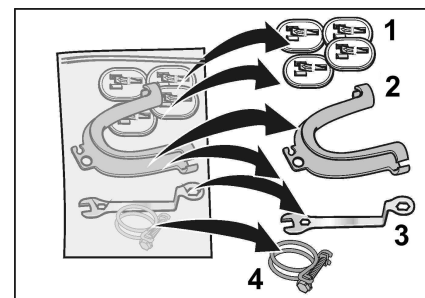

The accessory parts bag contains:

1. Covers to be placed over the holes for the transport bolts (after removing them).
2. Elbow for attaching the drain hose, e.g. to a sink.
3. Wrench for leveling.
4. Clamp for drain hose.

Depending on the type of connection, the following may also be required:

- Y-connector (can be obtained from any hardware store) in case there is only a cold water connection available.

Any residual moisture inside the drum is due to the final testing which every

washing machine undergoes before leaving the factory.

Connections located on the rear of the appliance:

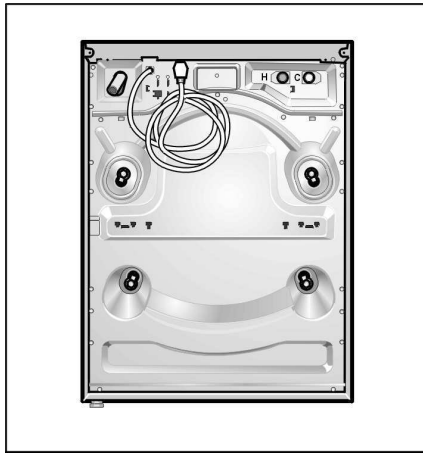

– Power cord with plug.

H = hot water connection

C = cold water connection

Useful tools

The following tools are helpful:

1. Flat head screwdriver.
2. Socket wrench (1/2" / 13mm).
3. Closed wrench (1/2" / 13 mm).
4. Bubble Level.

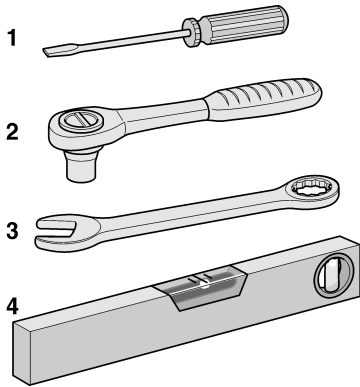

Dimensions

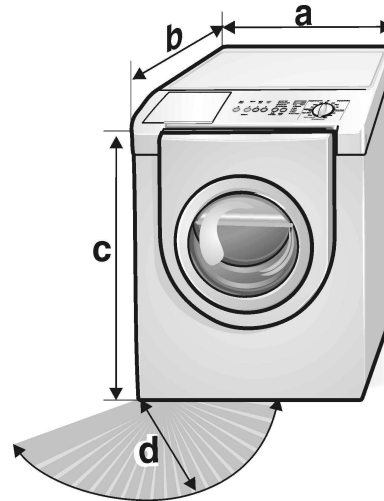

a = 27.0 inches (686 mm)

b = 30.7 inches (780 mm)

c = 37.0 inches (940 mm)

d = 16.0 inches (407 mm)

Door opening angle 180°

Approx. weight = 220 lbs (100 kg)

Installation area

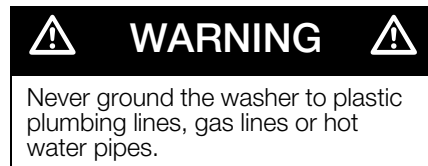

This appliance must be installed on a solid floor and well leveled due to the higher spin speeds available. If installing the machine on a wood floor over a basement or on a second floor, the floor may need to be reinforced. Sound, vibration, and risk of "walking" will be affected depending on the structure and stability of the floor surface where it is installed.

If the washing machine is to be installed on a weak wood floor consider the following:

- Soft floor surfaces, such as carpets or surfaces with foam backing, are not suitable. If possible, place the washing machine in a corner of the room.
- Screw a water resistant wooden board (at least 3/4" thick) to the floor.
- Secure the feet of the washing machine with holding brackets. Order the holding brackets (set) from Bosch Customer Service (WMZ 2200).

- Units are not designed to be stacked.
- Units are not designed for under counter installation

Pedestal Mounting

If mounting the washer on the Bosch pedestal accessory, follow the instructions supplied with the pedestal.

Pedestal Accessory Number

WTZ1295 for white variant

WTZ1295P for duo tone variant

i Install pedestal prior to removing transport bolts.

Closet

If installing the washer in a closet, observe the minimum distances according to the following table:

Minimum Installation Clearances

	Closet
Sides	1/4" (6 mm)
Top	12" (305 mm)
Rear	2.5" (64 mm)
Front	1/4" (6 mm)

Ventilation:

Top: 48 sq. in (310 sq. cm),

Bottom: 24 sq. in (155 sq. cm)

Checklist for Installation

Page

completely remove 4 shipping bolts and move the washer into place	8
connect the water supply line and drain pipe	8
connect the electrical power	10
slide the washer into its final location	11
level the washer as low as possible	11
before first use, run a cleaning cycle	15

Removing the transport bolts

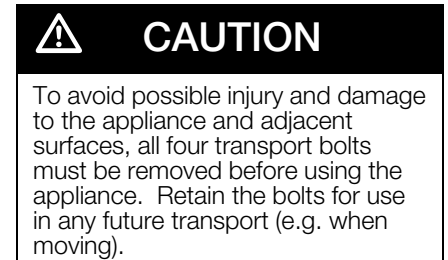

- ❑ Loosen all four bolts before removing any of the bolts all the way from the unit.
- ❑ Remove the bottom two bolts prior to removing the top two bolts.
- ❑ Loosen the bolts using the closed end of the 1/2" wrench provided. Loosen them until they can be removed freely.
- ❑ The recessed bottom bolts may be more easily removed using a 1/2" (13 mm) socket wrench.

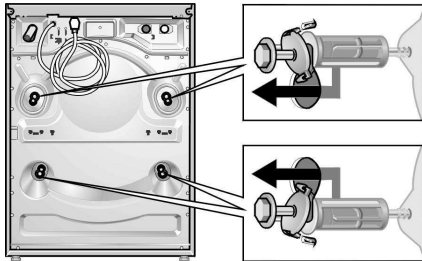

- ❑ Completely remove all 4 transport bolt assemblies (bolt, spring, washer and bushings) by reaching through the open washing machine door and pulling the drum slightly forward to loosen, then pull out from the back.
- ❑ If the bushings do not come out when removing the bolts, place the bolts back into the bushings and carefully try again. It is important to do this with the bolts, otherwise the bushings will not come out properly.
- ❑ To store the bolts for future use, do not remove the bolts from the plastic bushings.

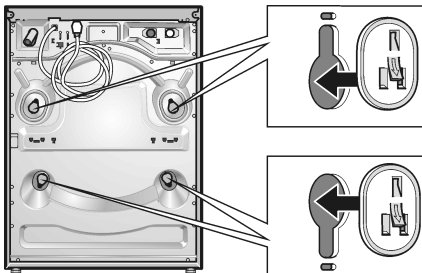

- ❑ Insert the covers until they snap in completely.

Storing the transport bolts

Always keep the transport bolts for future transportation of the appliance (such as when moving out).

- ❑ Store the transport bolts with the washer and bushing attached.

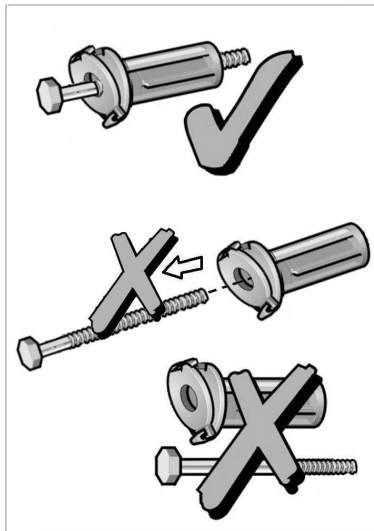

Water connection

Water supply

ATTENTION

The washing machine must only be operated with cold and hot (max. 140 °F / 60 °C) tap water. Do not connect the appliance to the mixer tap of an unpressurized hot-water boiler.

If in doubt, have the water connection installed by an authorized technician. The water supply hoses must not be:

- Bent or flattened.
- Modified or cut (integrity can no longer be guaranteed).

Observe the water pressure in the supply network:

- The water pressure should be between 14.5 and 145 p.s.i. (1 and 10 bars) when the tap is turned on, at least 2.2 U. S. gallons (8 liters) of water should be discharged per minute.
- A pressure regulator valve must be installed if the maximum water pressure is exceeded.

ATTENTION

To prevent water damage, the hot and cold water valves should be accessible when the washing machine is in place and should always be turned off when the washing machine is not in use.

ATTENTION

If installing the washing machine in a new building or a building in which the plumbing system was recently installed or upgraded, flush the lines before installing the washing machine to remove any sand, dirt or residue.

Supply Line Connection

C Cold water connection and
H Hot water connection
(max. 140 °F / 60 °C)

- ❑ Plastic threads must only be tightened **by hand** when connecting the water supply hoses to the back of the unit. Do not remove the strainers from the water supply hoses.

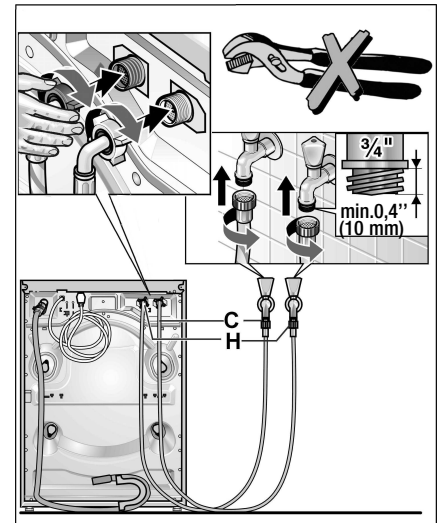

- ❑ After connecting, turn on the water completely, and check that connection points are watertight.



CAUTION

The connection points are under full water pressure. Check seal with tap fully open.

Water drainage

ATTENTION

Do not bend or pull the water drainage hose.

Height difference between the installation location of the washing machine and the drainage point:
Maximum 8 feet / 244 cm, minimum 2 feet / 60 cm.

Connecting the water drainage hose

- ❑ **Do not remove the screw from the clamp assembly.** Loosen the screw only enough so that the clamp will slide freely onto the water drain hose.

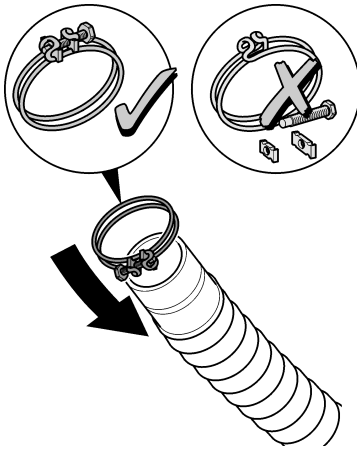

1. Place the hose clamp over the end of the drain hose before attaching the drain hose to the appliance.

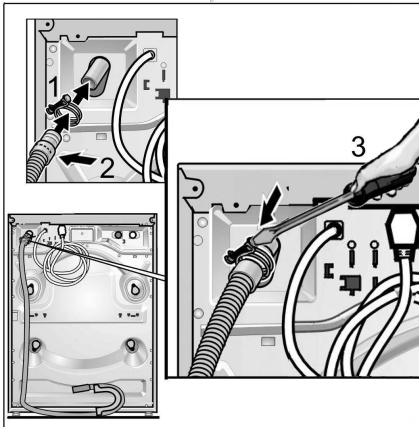

2. Attach the drain hose to the drain hose connection on the back of the appliance; position the hose clamp approximately 3/8 inch (9 mm) from the end of the hose.
3. Tighten the clamp with a screwdriver

Standpipe Installation

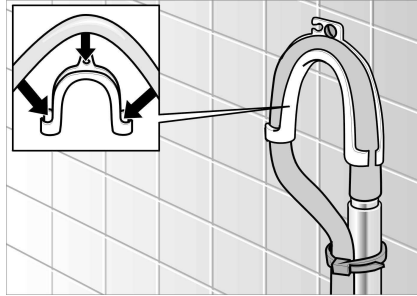

- ❑ Use the elbow. Attach the elbow to the end of the hose and insert end of hose into standpipe.
- ❑ Use a strap or cable tie to hold hose in place.

In-Wall Installation

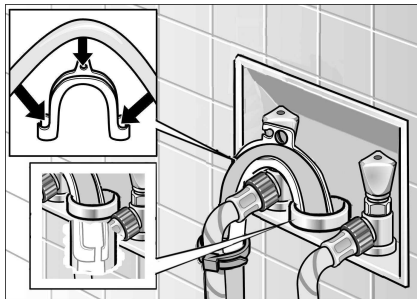

- ❑ Use the elbow. Attach the elbow to the end of the hose and insert the end of the hose into the wall drain.
- ❑ The hose and elbow should extend into the open drain pipe as far as the elbow allows when seated as shown in the above picture.
- ❑ Use a strap or cable tie to hold hose in place.

Drainage into a siphon

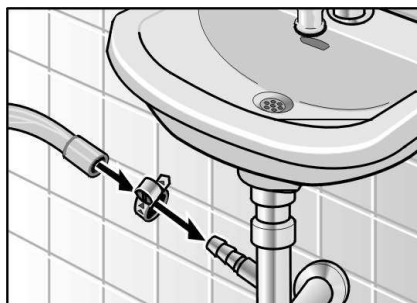

- ❑ Secure the connection point with a hose clip(not included in factory-supplied equipment).

Drainage into a sink

ATTENTION

Ensure that the plug is not in the drain hole.

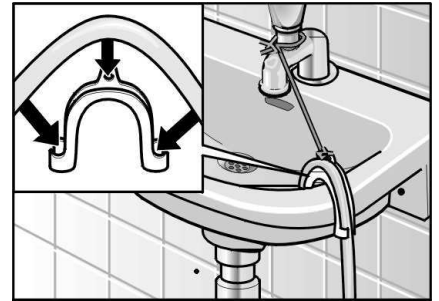

- ❑ Attach water drain hose securely to sink.
- ❑ Use a strap or cable tie to hold hose in place.
- ❑ When the water is being drained, check that the water flow out of the sink is adequate.

Hose and cable lengths

Left-hand connection

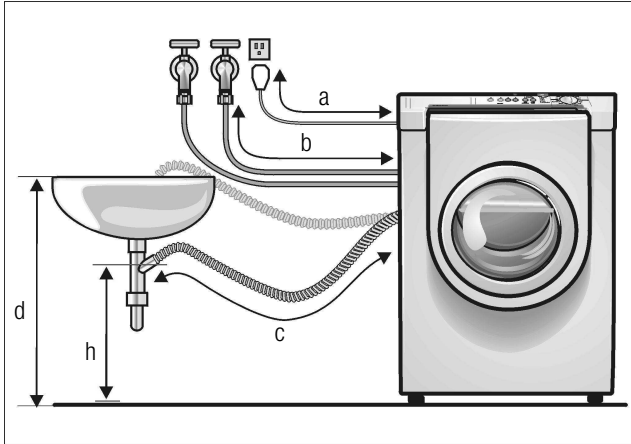

a = 55.0 in. / 140 cm (approx.)
 b = 51.0 in. / 130 cm (approx.)
 c = 33.5 in. / 85 cm (approx.)
 d = 39.0 in. / 100 cm (max.)

Right-hand connection

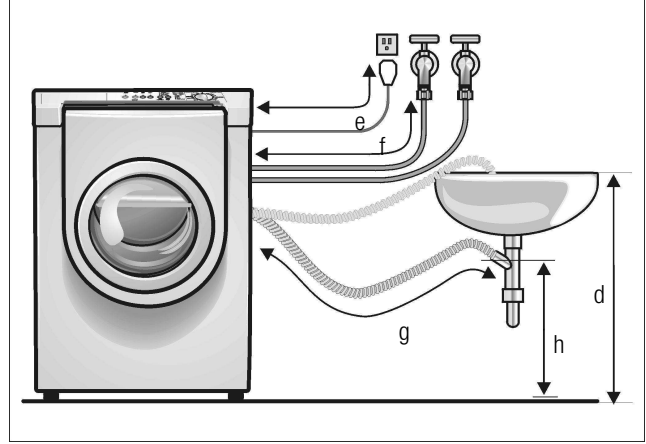

e = 69.0 in. / 175 cm (approx.)
 f = 34.6 in. / 88 cm (approx.)
 g = 55.0 in. / 140 cm (approx.)
 h = 24.0 in. / 60 cm (approx.)
 h = minimum drain point height

Other hoses

Available from appliance dealers:
 – Extended supply hose (approx. 96.1 in. / 2.44 m).

Electrical connection

GROUNDING INSTRUCTIONS

This appliance must be grounded. In the event of a malfunction or breakdown, grounding will reduce the risk of electrical shock by providing a path of least resistance for the electric current. This appliance features a cord with an equipment-grounding conductor and a grounding plug. The plug must be plugged into an appropriate outlet which has been properly installed and grounded in accordance with all local regulations and ordinances.

⚠ WARNING ⚠

Improper connection of the equipment grounding conductor may result in electric shock. Have the appliance checked by a qualified electrician or service technician if you are in doubt as to whether the washer has been properly grounded.

Do not modify the plug provided with the appliance – if it will not fit in the outlet, have a proper outlet installed by a qualified electrician.

⚠ WARNING ⚠

The washing machine must only be connected to an individual branch circuit via a socket which has been properly installed and grounded.

The household electrical voltage must correspond to the voltage specification on the washing machine (rating plate, see page 32).

Connection specifications as well as the required fuses are stipulated on the appliance rating plate.

Volts	Hertz	Amperes	Watts
110–120	60	15	1350 (max.)

Make sure that:

- the power plug fits into the socket.
- the wire size is sufficient.
- the grounding system is properly installed.

The power cord may be replaced by an electrician only. Replacement power cords are available from Customer Service.

⚠ WARNING ⚠

To reduce the risk of fire or electrical shock, DO NOT use an extension cord or an adapter to connect the washing machine to the power supply.

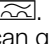
If a ground fault circuit breaker is to be used, only use types marked with the following symbol: . Only this symbol can guarantee compliance with all current regulations. Do not insert/remove the power plug with wet or damp hands. Touch the plug only when removing the plug from the socket.

Leveling Procedure

1. The appliance should now be in its final position, ready for leveling (moving the appliance after leveling can make it unlevel again.)

Each foot of the appliance or pedestal must be placed firmly on the floor to prevent the washing machine from wobbling.

Start with all four feet screwed in as far as possible, then back individual feet out as necessary to level the washer.

2. Use the bubble level to level the washer front to back and side to side (be sure the level fits between the edges of the washer, and is not elevated at one end on a ridge on the surface of the washer.)
3. Adjust the leveling of the washer with the four height-adjustable feet. Level the washer as low as possible to help reduce vibration.



CAUTION

TO AVOID RISK OF INJURIES—Take care when using the wrench.

- Loosen the lock nut (1 on the illustration) by turning it clockwise. Use the wrench provided (or a 5/8" – 16mm open end wrench). When you turn the lock nut, the foot (2 on the illustration) it is locked against will turn with it. This will extend the height of the foot.

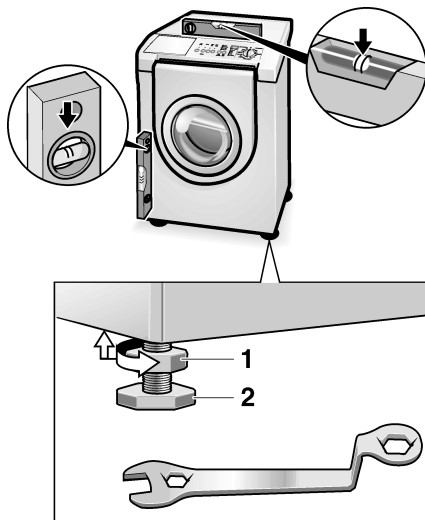

- Turning the foot out (clockwise) will raise the corner of the washer, turning the foot in (counter-clockwise) will lower the corner of the washer. When the corner of the washer is satisfactorily raised or lowered, lock the height-adjustable feet in place by turning the lock nut counter-clockwise until it locks tightly against the washer housing.

i It may be necessary to hold the washer foot with a pair of pliers to keep it from turning while tightening the lock nut. If the foot does turn, it will change the height of the corner.

- After making preliminary adjustments, press down on each corner of the washer to make sure the unit does not wobble. If it does wobble, lower the foot on that corner until the foot touches the floor firmly.

4. Use a bubble level (24" or less in length) to check the leveling status of the appliance.

- Lay the bubble level across the unit worktop to check the level from side to side and from front to back.

- A center-located bubble indicates the unit is leveled. Otherwise, repeat the leveling procedure until the unit is leveled. Tip: if the bubble is closer to one end, it indicates the high side of the unit. To level the unit, either lower the higher side or raise the lower side.

- After leveling the unit from side to side, then turn the level so that it lays on the worktop from front to back to also check the level in that direction.

5. Fine tune the leveling by placing a small load of laundry in the machine, starting it in spin cycle and then leveling the washer again.

i If the test spin cycle is manually stopped before its completion, then the door may remain locked for 10 seconds.

Transport, such as as when moving out

Before transporting the washing machine:

- Turn off the water.
- Disconnect the washing machine from the power outlet.
- Dismantle the supply and drainage hoses.
- Install the transport bolts.

Preparing and inserting the transport bolts

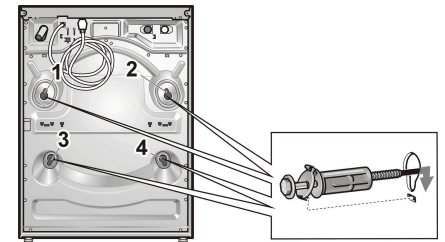

- Remove the covers.
- Prepare the transport bolts: Loosen the screw in the sleeve until the end of the screw is level with the end of the sleeve.
- Insert and tighten all transport bolts. Make sure that the tab on the transportation bolt is inserted in the slot on the washing machine back panel.

Panel

Buttons for additional options

(in addition to the program if required)

ECO: This option reduces the amount of energy used for the washing program.

Rinse plus: Additional rinsing cycle.

Reduced Ironing: A gentler spin speed with subsequent fluffing to reduce creasing.

Additional option selected:

Indicator light is lit red.

Switch off additional option:

Press button again. Indicator light turns off.

Display field

Indicates the settings which have been selected or which are to be changed (e.g. spin speed, finished at, pre-soak, time and child lock) as well as the program progress.

Program selector

Switches the machine on and off and selects the program. Can be turned in both directions.

The program selector does not turn while the program is running – the program sequence is electronically controlled.

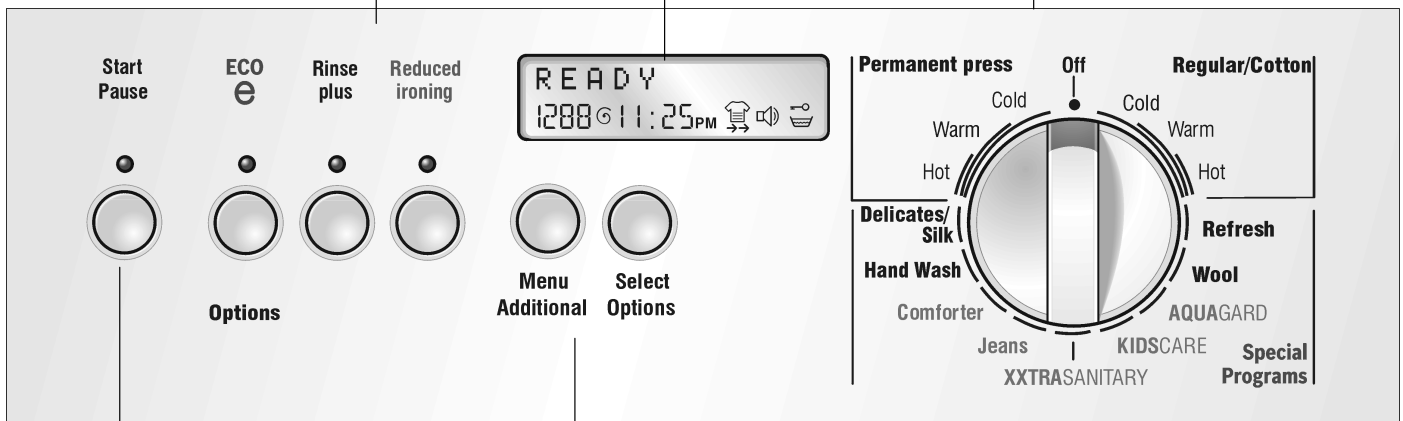

Start/Pause button

Starts or interrupts the washing cycle (program must first be selected).

Indicator light

Indicator light flashes red: Settings can be changed, the wash cycle can be started, door is locked for safety reasons, child lock is active or program is in "Pause" mode.

Indicator light is lit red: Program is running and "Pause" can be activated.

The indicator light is off: Program is finished or no program selected.

Menu

Selects the settings which are to be changed.

Select button

Changes all the settings in the display field.

Summary of instructions

Before using

⚠ Warning

Before using your washing machine, read and follow all installation and operating instructions.

- Set the time.
- Select the display panel language.

Preparing the laundry

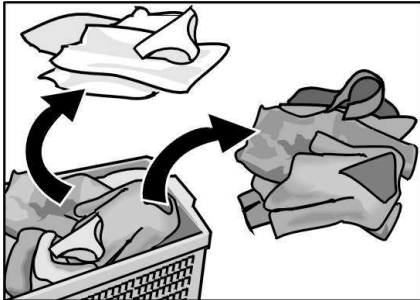

xxtra sanitary 170 °F 77 °C	KIDSCARE 150 °F 66 °C	hot 120 °F 49 °C
		warm 90 °F 32 °C
		cold 60 °F 15 °C

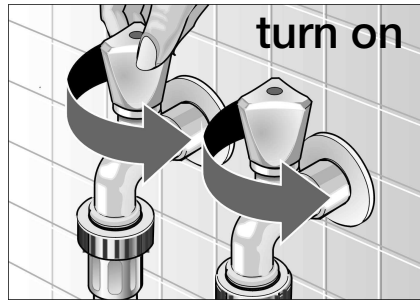
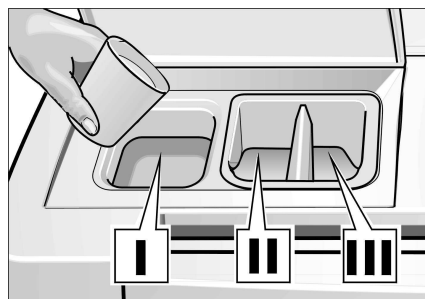

Select a cycle

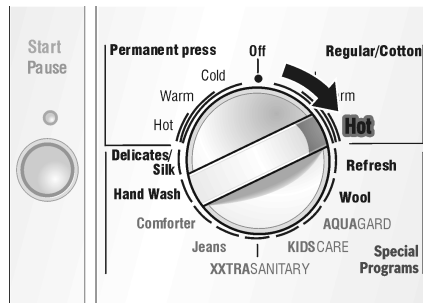

Select desired settings

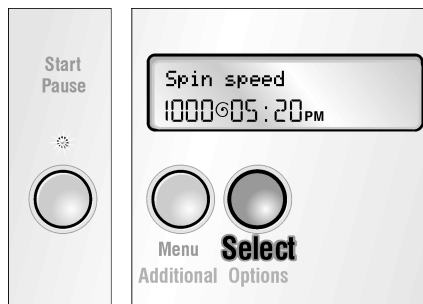
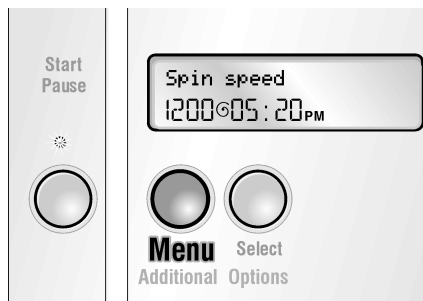

press start

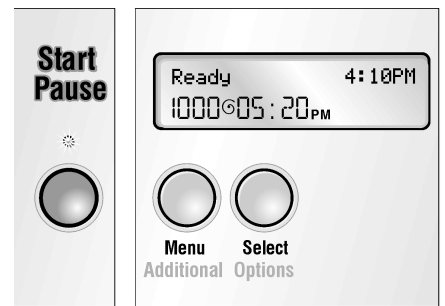

After washing

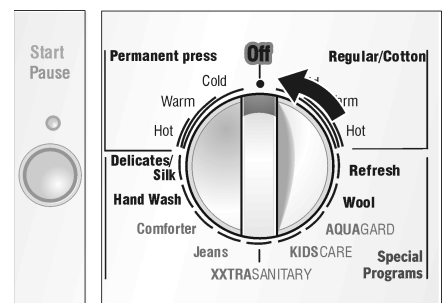

Before Using For the First Time

The washing machine must be installed and connected properly (refer to Page 6).

Before using your washing machine for the first time:

- Make sure that the supplied voltage is the same as the voltage shown on the rating plate.
- Check that the water valves for the washing machine have been connected correctly and are open.

Using For the First Time

Setting the time

i To define the individual settings (especially "Program finished at"), it is necessary to set the time first.

You can set the current time. The settings are retained even if your washing machine is not used for up to 6 weeks.

- Turn the program selector to the desired program.

Example:

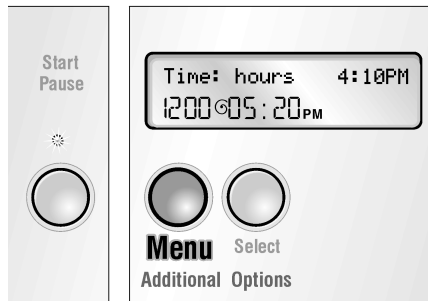

- Press the **Menu** button until "Time:" is displayed. The hours display flashes.

The **Start/Pause** indicator light flashes (red).

i If no buttons are pushed within 10 seconds the display will revert back to normal "Ready". Changed settings will be retained.

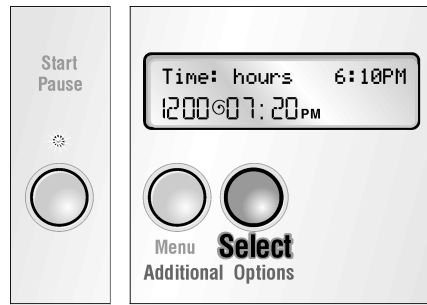

- Press the **Select** button until the hour display is correct.

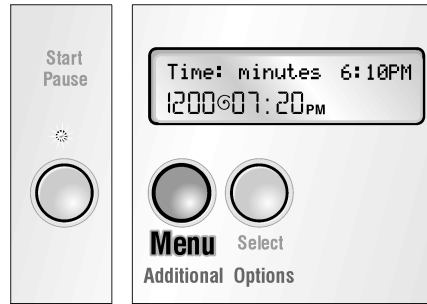

- Press the **Menu** button until the minutes display flashes. The **Start/Pause** indicator light flashes (red).

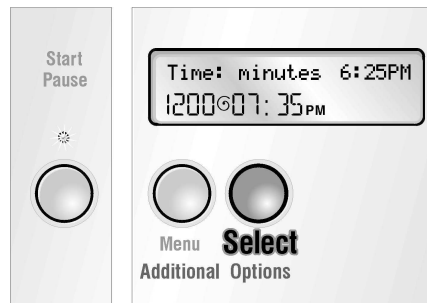

- Press the **Select** button until the minute display is correct. The time is now set.

i Press the **Menu** button, the menu function ends.

You can select other settings by pressing the **Menu** button and change them by pressing the **Select** button.

Selecting the language

i The time must be set before the language can be changed

i The program selector must not be set to **Off**.

i The language must be selected before a program is started.

- Simultaneously press the **Menu** and **Select** buttons and hold down (5 seconds) until the current setting is displayed.

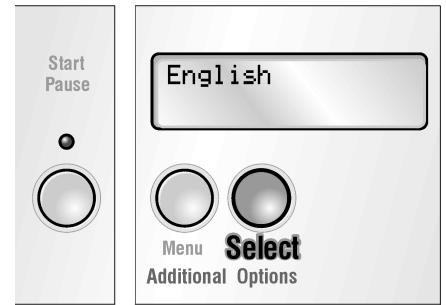

- Press the **Select** button until the desired language is displayed.
- Confirm the language selection by pressing the **Menu** button.

i The language selection can be confirmed either by pressing the **Menu** button or by leaving the selected language for five seconds.

i The selected setting is retained after the wash cycle.

First washing cycle (without laundry)

Your appliance was tested before leaving the factory. To ensure a fresh wash with your initial load of clothes, run the washer a complete cycle, without clothes, in advance.

- Do not load any laundry.
- Turn on the water tap.
- Open the flap of the detergent dispenser.
- Pour approx. 1 quart (1 liter) of water into the detergent chamber **I**; see Page 20.
- Pour 1–2 Tbsp. detergent into detergent chamber **I**.

i Do not use special detergents for delicates or wool (this will cause excessive sudsing).

Close the flap of the detergent dispenser.

Close the door.

Set the program selector to **Regular/Cotton hot**. The **Start/Pause** indicator light flashes (red).

Press the **Start/Pause** button. The program starts. The indicator light is on (red).

i The individual program steps are indicated in the display field.

When "Remove laundry" is displayed:

- Open the door.
- Turn the program selector to **Off**.

Preparing the laundry

ATTENTION

Loose debris (coins, paper clips, nails and other hard objects) can damage items of clothing as well as parts of the washing machine (e.g. drum).

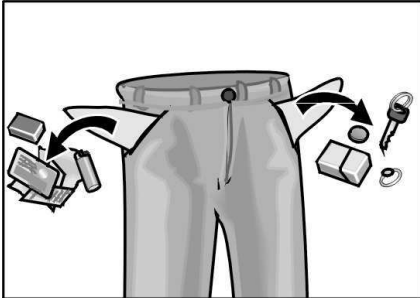

- Empty all pockets.
- Brush off lint and dirt.
- Close zippers, button up duvets and hooks.
- Remove curtain rings or tie them up in a net bag.
- Remove pins, buttons, buckles and other hard objects to avoid scratching the washer interior.
- Remove non-washable trim and ornaments.
- Turn synthetic knitwear inside-out to avoid pilling.
- Treat spots and stains.

To prevent loss or damage to laundry and the machine, the following items should be washed in a mesh laundry bag:

- Baby socks (small items)
- Hosiery
- Belts
- Underwired bras (directly washed in the washer, the wire may come loose during washing and cause damage)

Sorting the laundry

According to color and degree of soiling

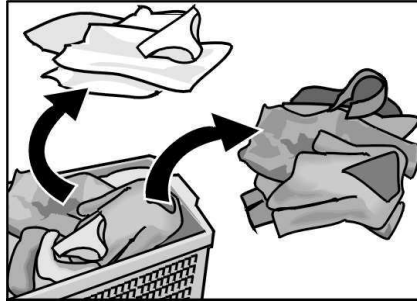

ATTENTION

Items of clothing may become discolored. Never wash new multi-colored items together with other items.

White items may become gray. Always wash white and colored items separately.

Degrees of soiling

Slight dirt

No recognizable dirt or staining. Laundry may have some body odor.

- Light summer clothing.
- T-shirts, shirts and blouses that have been worn for up to one day.
- Bed linen and guest towels that have been used for one day.

Normal dirt

Visible dirt and/or some light recognizable staining.

- T-shirts, shirts and blouses that are very sweaty or have been worn several times.
- Dish towels, hand towels and bed linen that have been used for up to one week.
- Sheer curtains (without smoke staining) that have not been washed for up to 6 months.

Intensive dirt

Dirt and/or staining recognizable.

- Kitchen hand towels that have been used for up to one week.
- Cloth napkins.
- Bibs.
- Children's outer clothing or sportswear with grass and soil stains.
- Working clothes such as overalls or baker's and butcher's coats.

Typical stains

- Body oils, cooking oils/grease, sauces, mineral oil, wax (containing fat/oil).

- Tea, coffee, red wine, fruit, vegetables.
- Blood, egg, milk, starch (containing protein/ carbohydrate).
- Soot, soil, sand (pigments), red clay.

Removing stains

If possible, pretreat stains while they are still fresh.

First, dab soapy water onto the stain. Do not rub.

Subsequently, wash the items of clothing using the appropriate program. Occasionally, several wash cycles may be required in order to remove persistent, dried on stains.

Sorting laundry according to care label specifications

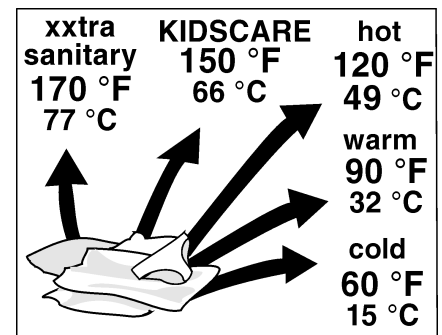

Fabric Types

- Machine Wash, Cottons
- Machine Wash, Permanent Press
- Machine Wash, Delicates
- Hand Wash



Temperatures

- Cold
- Warm
- Hot



Do not wash clothes in washing machine if the care label says "Do Not Wash" or the DO NOT WASH symbol ☒ is on the care label.

Loading the laundry

⚠ WARNING ⚠

TO AVOID EXPLOSION HAZARD! Items of clothing that have been pretreated with solvent-based cleaning agents, e.g. stain remover and dry cleaning solvents, represent an explosion hazard once loaded into the washing machine. Therefore, these items must first be rinsed thoroughly by hand.

ATTENTION

Loose debris in the washing machine drum can damage the laundry. Before loading the laundry, check that there is no debris in the drum.



- ❑ Open the door.



- ❑ Unfold the sorted items of clothing and place them loosely into the drum. Mix up large and small items. Items of varying size will distribute better during the spin cycle.

- i** Do not exceed the maximum load. Overloading will cause poor wash results and will increase wrinkling.

For best results it is recommended to load the drum depending on the fabric type, see special programs Page 18 for information on bulky items, e.g. comforters.

Full Load

Cotton and Linens

½ Load

Permanent Press, Synthetic Blends and Knitwear

⅓ Load
Wool, Delicates, Silk



- i** Close the door. Do not trap any items of clothing between the door and rubber seal. Door should be able to close easily, not by force.

Laundry Detergents and Additives

Dispensing the correct amount of detergent

⚠ WARNING ⚠

TO AVOID RISK OF POISONING!
Keep detergents and additives out of the reach of children.

Measure out the detergent (powder or liquid) according to:

- The water hardness. This information can be obtained from your local water authority. Soft water requires less detergent.
- The amount of laundry.
- The degree of soiling. Information on soiling can be found on Page 16.
- The specifications of the detergent manufacturer. Measuring the correct amount of detergent reduces the strain on the environment and ensures optimum washing results.

Too little detergent:

The laundry is not cleaned properly and will eventually become gray and stiff. Grayish brown spots (fat globules) may appear on the laundry. The heater may calcify.

Too much detergent:

Not environmentally friendly, excessive suds reduce wash agitation producing poor washing and rinsing results or may prevent proper spinning.

Filling laundry detergent and/or additives

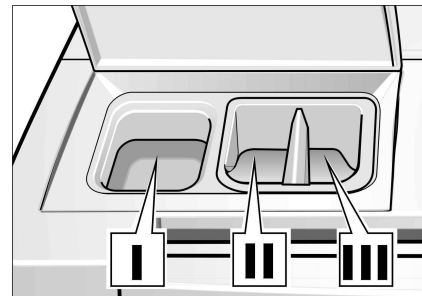

- ❑ Open the flap of the detergent dispenser.
- ❑ Add the detergent and/or additive.

Dispenser I:
Dispenser for detergent, stain remover.

- i** We recommend HE detergents because they are particularly designed to deliver optimum performance from your front-loading washer. Not using HE detergent could cause problems such as oversudsing, extended cycle periods, or a decrease in wash performance.

Dispenser II:
Cleaning additives, e.g. fabric softener, fabric conditioner. Do not fill over edge of max line!

Dispenser III:
Dispenser for liquid bleach (chlorine bleach, color safe bleach).
Do not overfill!

- i** Concentrated or thick fabric softener, conditioner and powder-bleach must be diluted with a little water before being poured into the dispenser (prevents overflow due to obstruction).
- i** Bleach may cause discoloration of the washer's colored surface. Therefore, it is important to keep the bleach away from the colored surface of your washer. If any bleach spills on the surface, use a moist paper towel to thoroughly clean it immediately.

- i** Close the flap of the detergent dispenser. Please ensure the lid is entirely closed.

Decolorizing

ATTENTION

Dyes may contain sulphur or chlorine. These substances may cause parts of the washing machine to corrode. Do not dye items of laundry in the washing machine.

Programs and Functions

Cycle time will vary depending on cycle selected, temperature and pressure of incoming water, water hardness, size of load, type of fabrics and distance of unit from the drain.

The maximum spin speeds of the programs are dependent upon the cycle. For adjusting the spin speed, see page 22.

Basic programs

Regular/Cotton Hot

Normally and/or heavily soiled colorfast fabrics. Sturdy, hard wearing items made of cotton or linen such as work clothes and underwear.

Regular/Cotton Warm

Lightly and/or normally soiled non-colorfast fabric. Sturdy, hard wearing items made of cotton or linen such as jeans, T-shirts and sweatshirts.

Regular/Cotton Cold

Lightly soiled non-colorfast fabric. Sturdy, hard wearing items made of cotton or linen (colors that may bleed or fade).

Permanent Press Hot

Items consisting of normally soiled colorfast cotton, permanent press, linen, synthetic or blended fabrics and outer garments. Clothes requiring a special tumble sequence and spin speed to minimize creasing.

Permanent Press Warm

Items consisting of lightly and/or normally soiled non-colorfast cotton, permanent press, linen, synthetic or blended fabrics and outer garments. Clothes requiring a special tumble sequence and spin speed to minimize creasing, such as blouses, shirts and overalls.

Permanent Press Cold

Items consisting of lightly and/or normally soiled non-colorfast cotton, permanent press, linen, synthetic or blended fabrics and outer garments. Clothes requiring a special tumble sequence and spin speed to minimize creasing.

Special programs

Delicates/Silk

Delicates/Silk settings are intended for use with delicate easy care items made of cotton, satin, synthetic or blended fabrics and curtains, dresses, skirts and blouses. No spinning between rinse cycles.

Hand wash

Hand Wash settings are intended for very delicate easy care items that usually require hand washing.

These cycles have been specifically designed to provide extremely gentle treatment of fabrics.

Silk or other items marked with the "Hand Wash" symbol  on the care label can be safely washed with this cycle.

Comforter

Specially designed program for large/bulky items. Extra water is used to ensure complete wetting and gentler spins to reduce stretching.

Jeans

Specially designed for jeans and heavy denims, this program reduces fading and wrinkling.

XXTRA SANITARY

This program was specifically designed to eliminate most common household bacterium while providing gentle treatment of fabrics. At the beginning of the washing phase, hot water is introduced and then the internal heating element heats the water to 167°F–174°F for a minimum of three minutes. Clothes will be saturated in the hot water long enough to kill most common household bacterium, yet without causing additional wear and tear to the clothes.

Used for heavily soiled and/or stained colorfast fabrics that need to be sanitized, such as, towels, underwear, socks, bed sheets, table clothes, etc.

KIDSCARE

Regular/Cotton settings are intended to be used for heavily soiled and/or stained colorfast fabrics. Sturdy, hard-wearing items made of cotton or linen such as towels, sheets or white sports socks.

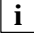
 Do not wash new multicolored laundry with other laundry together.

AQUAGARD

AQUAGARD is designed to work in conjunction with specially designed chemicals to rejuvenate the water-resistant qualities of sports- and outer-wear. The textiles are first cleaned with special detergents and then treated with water-proofing agents which are available at most department and sporting-goods stores.

Additional options which can be selected include "Rinse plus", "Reduced ironing", and "Power Wash" Maximum load is 3 lbs.

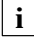
 Use special detergent! Pour into detergent (left) compartment.

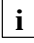
 Water-proofing agents must be added via the softener (middle) compartment.

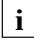
 Do not use fabric softener when washing water-resistant clothing! Textiles treated with fabric softener may lose their water-resistant properties.

Following application, some water-proofing agents require the textiles to be heat-treated in the tumble dryer or by ironing the textiles after they have been dried in air. The manufacturer's instructions should be followed carefully to ensure proper treatment.

Some residual water-proofing agent may be seen in the washing machine as a fine film. This film will be removed in the next full wash cycle (Regular/Cotton with detergent) and will not harm the items of clothing washed in subsequent programs. Alternatively, start a separate wash cycle. Wipe any film off the washing machine door with a damp cloth and household cleaner.

Wool

Woolens (machine wash and hand wash).

Refresh

Program for rinsing unsoiled textiles, e.g. swimwear, and for removing detergent residue from textiles. Ends with a spin cycle.

Maximum spin speeds of the programs

Revolutions per minute	Type of laundry/Extra cycle
1200	Regular/Cotton
800	Permanent Press
600	Delicates/silk
400	Hand Wash
600	Comforter
800	Jeans
1200	XXTRASANITARY
1200	KIDSCARE
600	AQUAGARD
800	Wool
1200	Refresh

In the **Regular/Cotton**, **XXTRASANITARY**, **KIDSCARE** and **Refresh** programs the fabrics will be spun at the maximum possible spin speed.

In the **Permanent press**, **Wool**, **Delicates/Silk**, **Hand Wash**, **Comforter**, **Jeans** and **AQUAGARD** programs, the washing machine spins at a lower spin speed for gentle treatment.

If required you can reduce the spin speed of laundry, minimum is 400 revolutions per minute.

Display field

In the first line, the operating and program progress text is displayed at the left. The current time is displayed on the right whenever "Ready" is displayed on the left.

In the second line, the display indicates the spin speed and the time at which the program is expected to be finished, as well as symbols for Spin speed, Washing mode, Pre-Soak, Signal and Child lock.

No final spin ("---")

The water is drained from the machine after the final rinse. Recommended for delicate laundry.

Use this setting to avoid creasing if the clothing cannot be taken out of the washing machine immediately upon completion of the cycle.

Program finished at

Indicates when the program will end.

Symbol for "Mode: Normal Wash"

This symbol is displayed if "Mode: Normal Wash" was selected.

Symbol for "Mode: Quick Wash"

This symbol is displayed if "Mode: Quick Wash" was selected.

Symbol for "Mode: Power Wash"

This symbol is displayed if "Mode: Power Wash" was selected.

Symbol for Pre-Soak

This symbol is displayed if **Pre-Soak: on** was selected in the menu.

Symbol for signal

This symbol is displayed if the signal volume was not set to **off**.

Symbol for child lock

This symbol is displayed if **Child lock: on** was selected in the menu.

Option buttons

ECO e

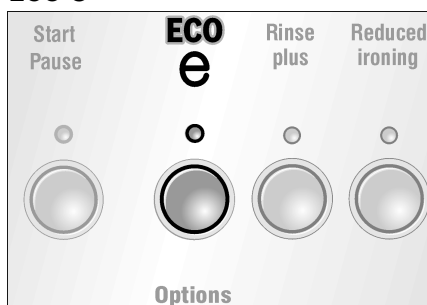

This option reduces the amount of energy used for the washing program by reducing the wash temperature and increasing the washing time. This option is not available for cold programs.

Rinse Plus

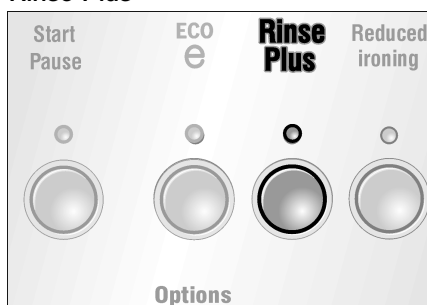

When this button is pressed, an additional rinsing cycle will be added to the selected cycle.

Washing cycle time is extended accordingly.

Reduced Ironing

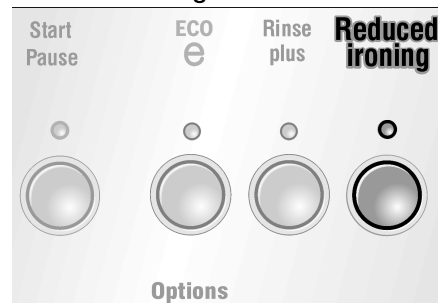

When this button is pressed, a gentler spin speed with subsequent fluffing is used. After the spin cycle the laundry is arranged loosely in the drum – wrinkling is reduced. Washing cycle time is extended accordingly.

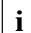
 Remove the laundry as soon as the spin cycle is complete.

Indicator light above the "Start/Pause" button

The indicator light conveys the following information:

- Indicator light **flashing red**: Program can be started. Adding laundry is possible
- Indicator light is lit **red**: Program is running. Adding laundry is not possible because the door is locked for safety reasons.

Laundry may be added after pressing the **Start/Pause** button.

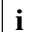
 **Exception:** If the child lock was selected, the indicator light is off. At the end of the program, the door is locked!

Special features

Auto Load adjust

"Auto Load adjust" adjusts the water and energy consumption for each program and determines the amount of laundry and type of fabrics.

This process is built into your machine and occurs automatically.

This control reduces water and energy consumption when washing small loads.

A flow sensor measures the water flow rate and meters the exact volume of water required for the load.

This sensor ensures the water level is correct for washing your laundry – from our economical "Regular/ Cotton" and "Permanent Press" programs to the "Delicates/Silk", "Hand wash", "Wool", "AQUAGARD" and "XXTRASANITARY" cycles.

Unbalanced load detection system

The automatic unbalanced load detection system spins the laundry several times to ensure even distribution.

If the wash load is unevenly distributed, it will not spin (for safety reasons) or the final spin speed is reduced.

In the wool program the appliance will attempt to start the spin cycle only twice in order to prevent shrinking.

Displayed Time

Due to these and other characteristics of the controls the actual cycle time will vary.

When a program has been selected, the expected cycle time is displayed. The following will effect the displayed time:

- Load size
- Repeated spin attempts to evenly distributed load
- Additional rinse cycles if excessive foam occurs
- Water pressure is too low
- Selection of additional options, e.g. "Rinse plus"



You may notice these effects (more or less time) changing the displayed time when they occur in the cycle. If no options are selected and these effects do not occur, the time indicated will be time that the cycle will finish.

Washing with Standard Settings

The specified standard settings are optimized for the selected program. If you do not want to change these standard settings:



- Turn on the water taps.

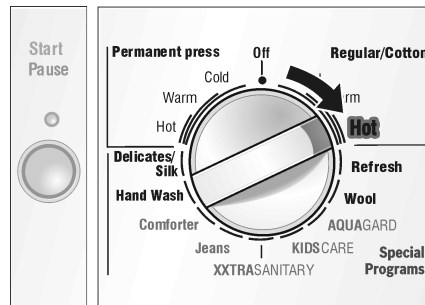

- Turn the program selector to the desired program.



- Load the washing machine and close the door.

The **Start/Pause** indicator light flashes (red).

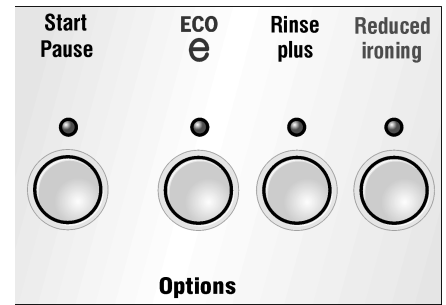

- If necessary, press the button(s) for additional option(s). The indicator light of the selected button is lit (red).

- i** If an incorrect combination was inadvertently selected, the indicator light of the selected button is turned off and a signal is emitted.

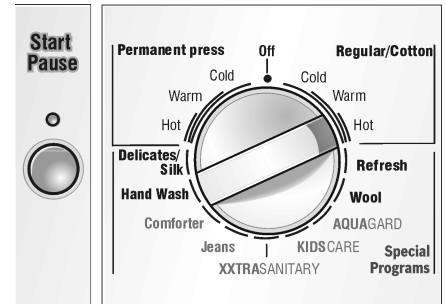

- Press the **Start/Pause** button. The indicator light is lit (red). The program starts.

- i** Each program step is indicated in the display field.

Washing with individual settings is described on the next page.

Washing with Individual Settings

The individual settings may be adjusted to your requirements.

Below is a quick overview of the adjustable settings.

The steps for changing the settings are described in detail in the following pages.

Quick overview

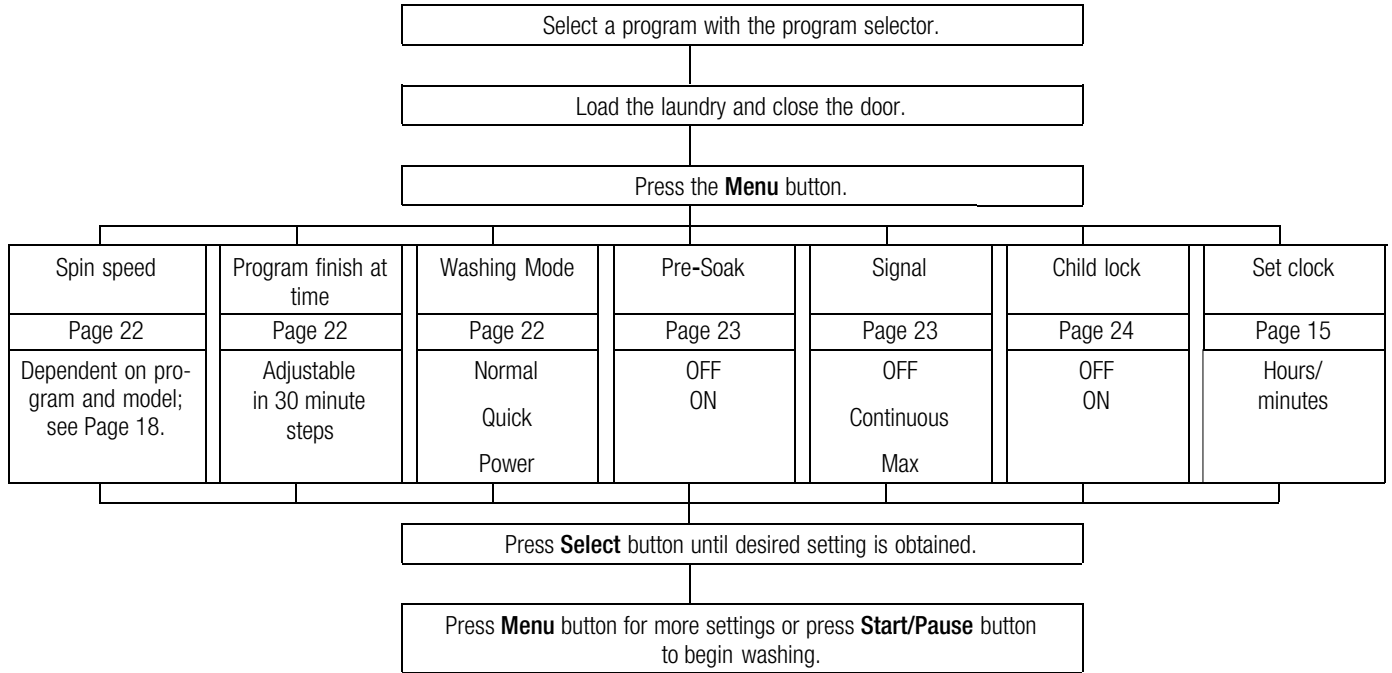

Spin speed

The maximum spin speed can be reduced.

The maximum spin speed depends on the selected program: see also information on Page 18.

- Turn the program selector to the desired program.
- Load the laundry and close the door.
The **Start/Pause** indicator light flashes (red).

Example:

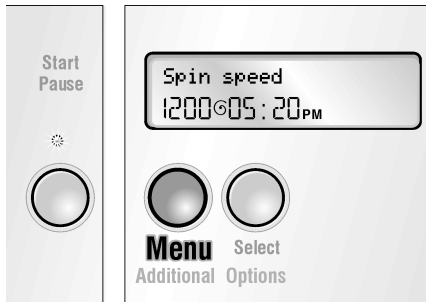

- Press the **Menu** button until "Spin speed" is displayed. Current spin speed flashes. The **Start/Pause** indicator light flashes (red).

- i** If no buttons are pushed within 10 seconds the display will revert back to normal "Ready". Changed settings will be retained.

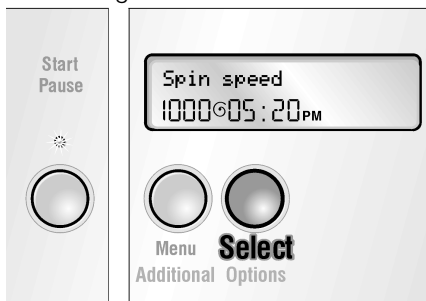

- Press the **Select** button until the desired spin speed or "No final spin" is displayed.

You can select other settings by pressing the **Menu** button and change them by pressing the **Select** button.

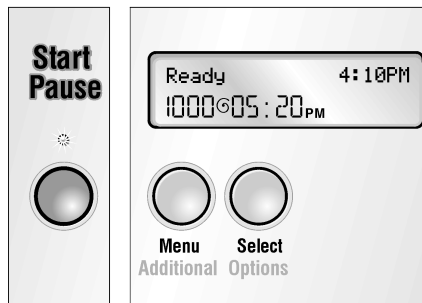

- Press the **Start/Pause** button. The program starts. The indicator light is lit red.

- i** The individual program steps are indicated in the display field.

Program finished at

- i** To change the program end time the clock must be set first (see Page 15).

- Turn the program selector to the desired program.
- Load the laundry and close the door. The **Start/Pause** indicator light flashes (red).

Example:

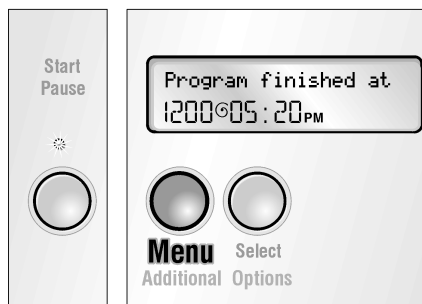

- Press the **Menu** button until, "Program finished at" is displayed. Current end time flashes. The **Start/Pause** indicator light flashes (red).

- i** If no buttons are pushed within 10 seconds the display will revert back to normal "Ready". Changed settings will be retained.

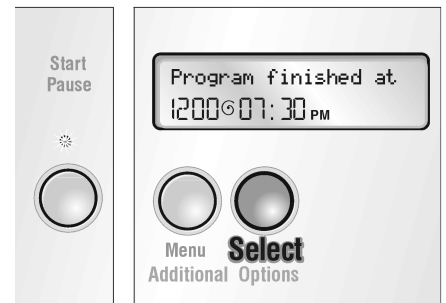

- Press the **Select** button until the program end time is displayed. The program end time can be set in 30 minute steps. The end time can be programmed up to a maximum 24 hours in advance.

- i** The end time will be reset if the program, additional options or the current time is changed.

- i** If there is a small load of lightly soiled laundry, the program may end well before the selected end time.

- i** If there is a large load of heavily soiled laundry, the program may end several minutes after the selected end time.

You can select other settings by pressing the **Menu** button and change them by pressing the **Select** button.

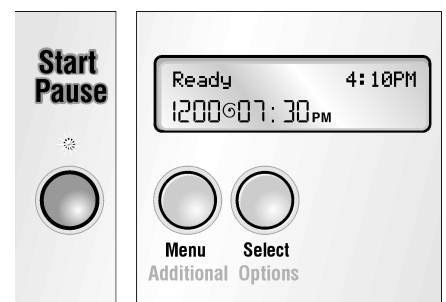



- Press the **Start/Pause** button. The delayed Start is activated. The indicator light is lit. "Time delay" is indicated in the display field.

Washing Mode

You can choose several washing modes.

The Modes are:

- "Normal Wash"  Default wash time.
- "Quick Wash"  Reduced wash time for light soils and shorter cycle time.

- "Power Wash" 

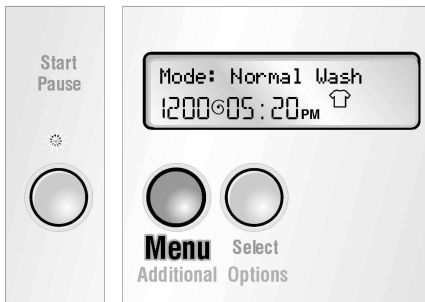

The Power Wash option is recommended for use **ONLY** for **heavily soiled clothes that require the removal of tough, ground-in protein-based stains**. It is **NOT** recommended to use the Power Wash option with other cycles when laundering normal or lightly soiled clothes.
- Turn the program selector to the desired program.
- Load the laundry and close the door. The **Start/Pause** indicator light flashes (red).

Example:

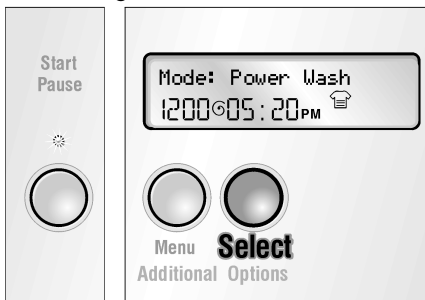

- Press the **Menu** button until, "Mode: Normal Wash" is displayed. The " " symbol flashes. The **Start/Pause** indicator light flashes (red).
- i** If no buttons are pushed within 10 seconds the display will revert back to normal "Ready". Changed settings will be retained.



- Press the **Select** button until the desired washing mode is displayed.
- i** If "Power Wash: on" or "Quick Wash: on" were selected, the " " or " " symbol are permanently displayed when the menu is left.

You can select other settings by pressing the **Menu** button and change them by pressing the **Select** button.

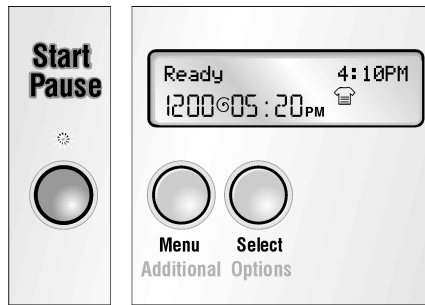

- Press the **Start/Pause** button. The program starts. The indicator light is lit.
- i** The individual program steps are indicated in the display field.

Pre-Soak

An integrated pre-soak cycle for pre-treatment of heavily stained items.

- Turn the program selector to the desired program.
- Load the laundry and close the door. The **Start/Pause** indicator light flashes (red).

Example:

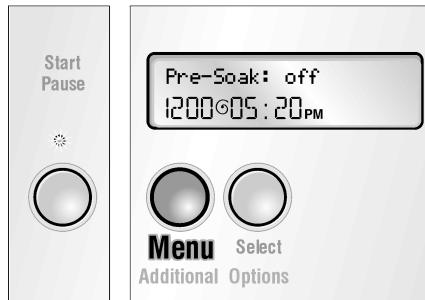

- Press the **Menu** button until "Pre-Soak: off" is displayed. The " " symbol flashes. The **Start/Pause** indicator light flashes (red).
- i** If no buttons are pushed within 10 seconds the display will revert back to normal "Ready". Changed settings will be retained.

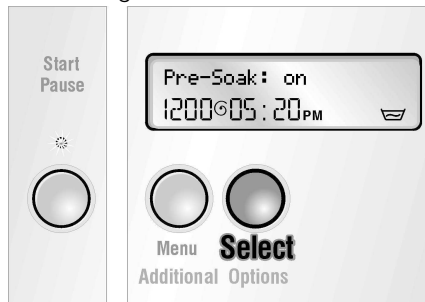

- Press the **Select** button until "Pre-Soak: off" or "Pre-Soak: on" is displayed.

- i** If "Pre-Soak: on" was selected, the " " symbol is permanently displayed when the menu is left. You can select other settings by pressing the **Menu** button and change them by pressing the **Select** button.

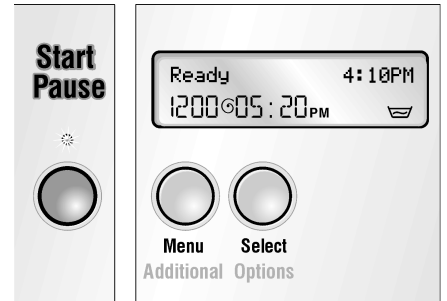

- Press the **Start/Pause** button. The program starts. The indicator light is lit red.
- i** The individual program steps are indicated in the display field.

Signal

The acoustic signal indicates the start or end of the program, operating errors or malfunctions.

You can specify the volume of the acoustic signal.

Activating, specifying the signal volume and deactivating the signal

- Turn the program selector to the desired program.
- Load the laundry and close the door. The **Start/Pause** indicator light flashes (red).

Example:

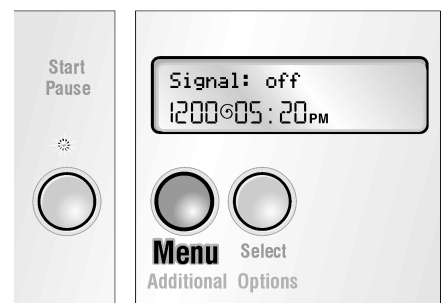

- Press the **Menu** button until "Signal: off" is displayed. The " " symbol flashes. The **Start/Pause** indicator light flashes (red).

- i** If no buttons are pushed within 10 seconds the display will revert back to normal "Ready". Changed settings will be retained.

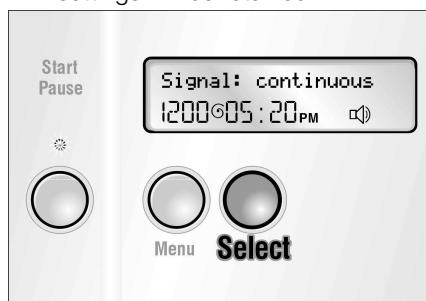

- Press the **Select** button until "Signal: continuous" is displayed. While holding down the **Select** button the volume of the acoustic signal will increase. When the signal has reached the required volume, release the **Select** button.
- Hold down the **Select** button after 10 seconds the display indicates "Signal: max".
- To deactivate the signal, when the display indicates "Signal: max", hold down the **Select** button, after 10 seconds the display indicates "Signal: off".

- i** The selected setting is retained after the washing cycle. You can select other settings by pressing the **Menu** button and change them by pressing the **Select** button.

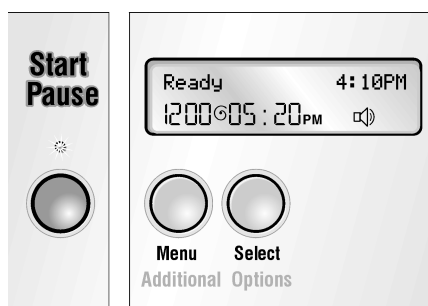

- Press the **Start/Pause** button. The program starts. The indicator light is lit.
- i** The individual program steps are indicated in the display field.

Child lock

You can secure your washing machine to prevent selected functions from being changed inadvertently.

If the child lock has been selected:

- No changes can be made while the program is running.
- The door remains locked at the end of the program.

Activating the child lock

- Turn the program selector to switch on the appliance.

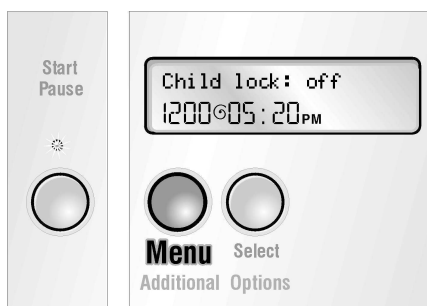

- Press the **Menu** button until "Child lock: off" is displayed. The "→○" symbol flashes.

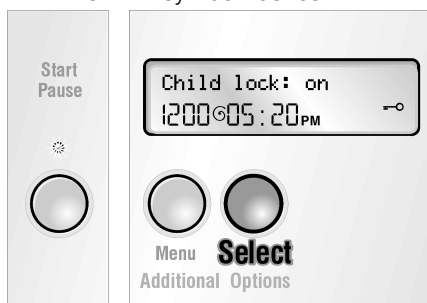

- Press the **Select** button until "Child lock: on" is displayed. When the menu is left, the "→○" symbol is permanently displayed.

- i** You can set child lock on/off before starting a program or in "Pause" mode only.

Starting a program with "child lock: on"

- Turn the program selector to the desired program.
- Load the laundry and close the door. The **Start/Pause** indicator light flashes (red).

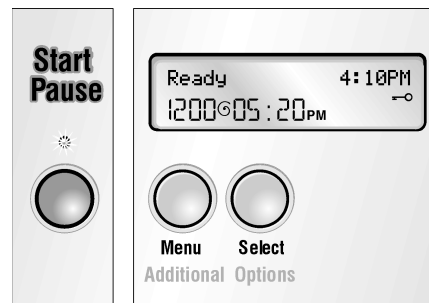

- Press the **Start/Pause** button and hold down (5 seconds). The program starts. The indicator light is lit (red). The child lock is activated.

- i** To deactivate the child lock temporarily press the Start/Pause button again(5 seconds) until the Start/Pause indicator light flashes. Now you can change programs or options. Press the Start/Pause button to reactivate the child lock.

- i** You can stop a running program with activated child lock turning the program selector to "off"! When you switch it on again the interrupted program will continue.

Unloading laundry at the end of a cycle with "child lock: on"

- Press the **Start/Pause** button and hold down (5 seconds). You can open the door and remove laundry. The child lock setting remains activated even if you switch off the appliance.

- i** Next time you switch on the appliance child lock is activated. The door is locked and no changes can be selected. Press the Start/Pause button (5 seconds) to open the door.

Deactivating the child lock

- Turn the program selector to the desired program to switch on the appliance.
- Press the **Menu** button until "Child lock: on" is displayed. The "→○" symbol flashes.
- Press the **Select** button until "Child lock: off" is displayed.
- i** You can set child lock on/off before starting a program or in "Pause" mode only.

During Washing

i Due to the highly engineered suspension of this appliance, it may experience a shudder or shake when progressing from lower to higher spin speeds. This behavior is normal due to shifting of the drum system and should not cause concern.

Re-selecting a program

- If the child lock is active, temporarily deactivate it. See page 24.
- Turn the program selector to **Off**.
- Turn the program selector to a newly selected program. The **Start/Pause** indicator light flashes.
- If the child lock is active, deactivate again temporarily.
- If required, change the settings. See Page 24.
- Press the **Start/Pause** button. The program starts. The indicator light is lit.

Add a garment / Interrupting the program

You can put laundry in the drum after washing begins, take laundry out of the drum early or interrupt the program at any time.

i It is not recommended to add laundry after the washing phase is complete.

Without child lock

- i** You can add or reduce laundry as long as the **Start/Pause** indicator light flashes (red).
- Press the **Start/Pause** button. The following displays are indicated in succession: "Pause", "Door can be opened".
- Open the door.
- Add/remove the laundry.
- Close the door.
- Press the **Start/Pause** button. The program continues. The indicator light is lit (red).

i When the **Start/Pause** indicator light is lit (red), the program can be interrupted, however the door cannot be opened for safety reasons (water level, temperature or drum speed too high). The following displays are indicated in succession: "Pause", "Door cannot be opened".

i If the speed is too high, the **Start/Pause** indicator light is lit (red). Laundry can be added in "Pause" mode when the drum is at a standstill.

Child lock activated

Press the **Start/Pause** button and hold down (5 seconds), child lock is deactivated and program will be interrupted.

i If the **Start/Pause** indicator light is lit (red), the door cannot be opened for safety reasons (water level, temperature or drum speed too high). The following displays are indicated in succession: "Pause", "Door cannot be opened".

i If the **Start/Pause** indicator light flashes (red), the laundry can be added or removed. The following displays are indicated in succession: "Pause", "Door can be opened".

- Open the door.
- Add/remove the laundry.
- Close the door.
- Press the **Start/Pause** button. Program continues. Child lock is reactivated. The indicator light is lit (red).

Canceling the active program

If you would like to terminate a program and remove the laundry:

- Press the **Start/Pause** button and hold down (5 seconds) if child lock is active.
- Turn the program selector to **Refresh**.

i If a program is interrupted at a high temperature, allow the laundry to cool down until doorglass is not too hot to touch.

- Press the **Start/Pause** button.

- Wait until the program ends.
- Press the **Start/Pause** button and hold down (5 seconds) if child lock is active.
- Open the door.
- Unload the laundry.

i If a program is interrupted at a high temperature, the door may remain locked until the appliance has cooled down.

i If the program is terminated by switching off the appliance, the door may remain locked.

After Washing

The **Start/Pause** indicator light goes out.
 Display field: "Remove laundry".



- Open the door.

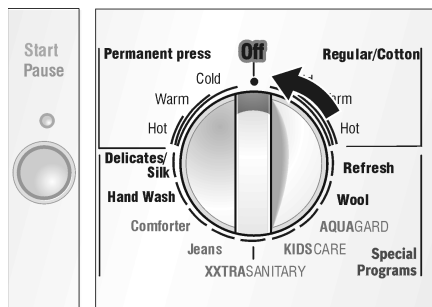

- Turn the program selector to **Off**.

"Child lock: on" preselected

The **Start/Pause** indicator light is lit (red).
 Display field: "Remove laundry".

- Press and hold down the **Start/Pause** button (5 seconds) until "Pause" is displayed. The **Start/Pause** indicator light flashes (red).
- Open the door.
- Turn the program selector to **Off**.



- Close the taps.



- Remove the laundry.

- i** The child lock is reactivated as soon as the appliance is switched on again.

ATTENTION

Occasionally check for any foreign objects (e.g. coins, paper clips) between the drum and rubber seal – **To avoid risk of rust!**

- i** After washing, leave the loading door ajar to allow the inside of the washing machine to dry.

User Maintenance Instructions

Cleaning and Care

⚠ WARNING ⚠

TO AVOID RISK OF ELECTRIC SHOCK!
Always disconnect the appliance from the power outlet before cleaning.
Never clean the washing machine with a pressure washer.

⚠ WARNING ⚠

TO AVOID RISK OF EXPLOSION!
Never use flammable solvents to clean the appliance.

Cleaning the appliance housing and control panel

As required:

- ❑ Use hot soapy water or a mild, non-abrasive cleaning agent.
- ❑ Rub dry with a soft towel.

Cleaning the drum

If rust spots have formed due to left-over debris (e.g. coins, paper clips, nails):

- ❑ Use a chlorine-free cleaning agent. Follow the manufacturer's instructions. Never use steel wool.

Cleaning the detergent dispenser

If residual detergents or additives have accumulated or if softener/bleach are not fully rinsed out:

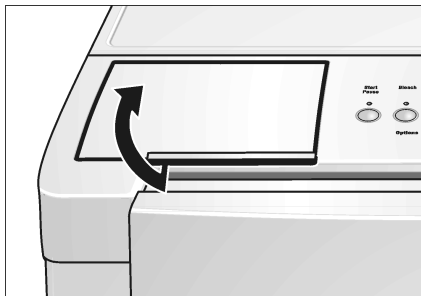

- ❑ Open the flap of the detergent dispenser.

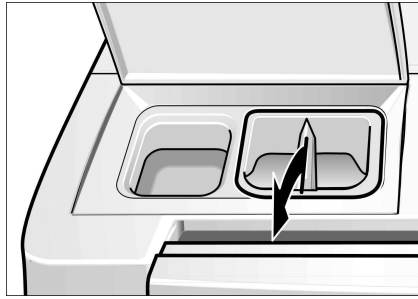

- ❑ Pull out the softener/bleach compartment in a vertical direction and remove.
- ❑ Clean the detergent dispenser insert under running water. The detergent dispenser can be disassembled into two parts!

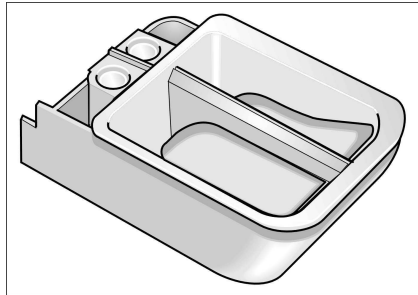

- ❑ Insert the detergent dispenser until it clicks into place.

Cleaning water inlet strainers

This is necessary if very little or no water flows into the washing machine.

First release the water pressure in the supply hoses:

- ❑ Turn off the water taps.
- ❑ Turn the program selector to any program.
- ❑ Press **Start/Pause** button and wait for "Water tap closed?" message.
- ❑ Turn the program selector to **Off**.

Cleaning the strainer(s) on the water tap

On both the hot and cold water tap:

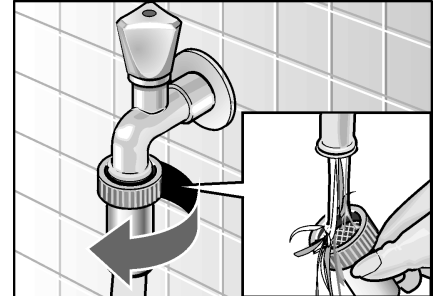

- ❑ Disconnect the hose from the water tap.
- ❑ Rinse the strainer under running water.
- ❑ Reconnect the hose.

Cleaning the strainers on the washing machine

On both the hot and cold water tap:

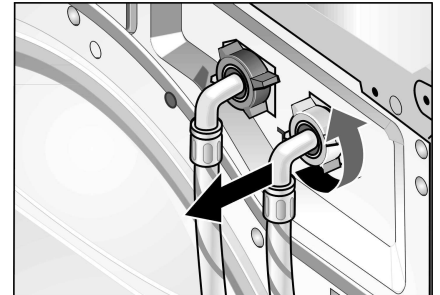

- ❑ Disconnect the hose from the back of the washing machine.

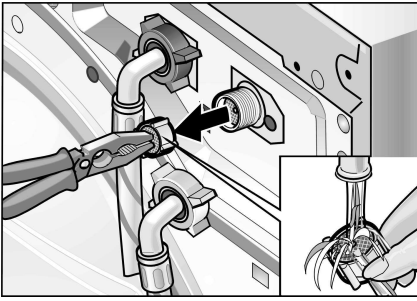

- Pull out the strainer and rinse under running water.
- Insert the strainer and reconnect the hose.
- Turn on the water taps and check that there are no leaks. If water is leaking, check that the strainer is properly attached.
- Turn off the water taps.

Cleaning Tips

It is recommended that a small amount of household bleach be run through the washer every 3 months.

With no laundry in the machine, run the machine as follows:

- Pour 1 cup of bleach in Detergent compartment of the dispenser
- Run a Regular/Cotton Hot program

Descaling the washing machine

ATTENTION

Descaling agents contain acids which may attack parts of the washing machine and discolor the laundry.

Provided that you use the correct type of detergent, it is not necessary to descale the washing machine.

If white spots, lime or mineral deposits appear on the interior of the washing machine drum you can use a descaling agent to remove them.

However, if the appliance has to be descaled, please follow the instructions provided by the descaling agent manufacturer.

Troubleshooting of Minor Faults

⚠ **WARNING** ⚠

TO AVOID
RISK OF ELECTRIC SHOCK!
Repairs should only be carried out
by an authorized technician.

If repairs are necessary, and you cannot eliminate the fault yourself with the aid of the following table:

- Turn the program selector to **Off**.
- Disconnect the washing machine from the power outlet.
- Turn off the water taps.
- Call Customer Service (refer to Page 32).

Fault	Possible cause	Action
The door cannot be opened.	Child lock activated.	Deactivate child lock; see Page 24
	Power failure.	An interrupted program will be resumed when power is restored. If the laundry is to be removed during a power failure, call Customer Service (refer to Page 32).
	Program is running and/or the door is locked for safety reasons.	Wait until the program ends; see Page 25.
	Plug is loose or not inserted.	Eliminate the cause.
Door cannot be opened, even though the appliance has been switched off and on again.	Program selector turned to Off before end of program.	Select a program.
	Child lock activated.	Deactivate child lock, see Page 24.
Door cannot be opened, even though the appliance has been switched off and on again.	For safety reasons the door has been locked because the water level, temperature or drum speed is too high.	See "Adding to the laundry/Interrupting the program", Page 25 .
Program continues running, even though the appliance has been switched off and on again.	Child lock activated.	Deactivate child lock; see Page 24.
Appliance cannot be operated. "Child lock activated" as indicated in the display field.	Child lock activated.	Deactivate child lock; see Page 24.
Control lights do not light up.	A fuse has blown.	Reset circuit breaker.
	Power failure.	Call Customer Service if this fault recurs.
	Appliance is in energy-saving mode. This is not a fault.	An interrupted program will be resumed when power is restored. If the laundry is to be removed during a power failure, call Customer Service (refer to Page 32).
Program does not start. Start/Pause indicator light flashes.	Start/Pause button not pressed.	Press the Select button; energy-saving mode is terminated.
		Press the Start/Pause button.
Program does not start. "Check Door !" indicated in the display field.	Door not closed properly.	Check whether laundry is trapped in door.
		Close the door (a click should be heard). Program continues.
"Press start" is indicated in the display field.	End time selected but still not activated by pressing the Start/Pause button.	Press the Start/Pause button.

Fault	Possible cause	Action
Program does not start. "Real Time delay" is indicated in the display field.	End time selected and activated.	None. Appliance starts automatically.
Clock cannot be set.	Program has already started; when a program has started, the clock cannot be set.	Wait until program ends.
"Set clock:" text remains in the display field even though the Menu button has been pressed.	The setting has switched from hours to minutes; both selection points have the same text.	None.
No time displayed.	Time not set.	Set time; see Page 15.
End time cannot be selected.	Time not set.	Set time; see Page 15.
	Program has already started; when a program has started, the end time can no longer be selected.	Before starting the program, select and start the desired end time; see Page 22.
Spin speed cannot be selected.	Spinning is already in progress; during spin cycle the speed cannot be changed.	Select speed before spinning.
Child lock cannot be selected.	The program has already started.	Child lock can be selected in pause mode.
Detergent residue in the detergent dispenser.	Detergent was damp or lumpy.	Clean and dry the detergent dispenser; see Page 27. Use the cap of the detergent bottle to measure liquid detergents.
Water does not enter the machine or detergent is not washed away. "Water tap closed?" indicated in the display field.	Water tap not turned on.	Turn on water tap. Program continues.
	Supply hose kinked or pinched.	Eliminate the cause.
	Strainers in supply hose clogged.	Clean the water inlet strainers; see Page 27.
	Water pressure too low.	Eliminate the cause.
Water cannot be seen in drum.	This is not a fault. The water level is below the visible part of the drum.	
Washing solution has not drained completely. "Suds or blocked pump?" indicated in the display field.	Suds or pump is blocked	Use less detergent for future wash loads. Detergents specifically designed for your High Efficiency washer produce fewer suds and will include the letters "HE" on the packaging. Clean the water drainage pipe and/or drain hose.
Water is flowing out from underneath the machine.	The thread of the supply hose is not tight.	Tighten the thread.
	Leak in the drain hose.	Replace the drain hose.
Suds coming out of the detergent dispenser.	Too much soap or non-HE soap used, pump could not remove suds.	Mix 1 tablespoon of fabric softener with 1 pt (½ litre) of water and pour into detergent dispenser I . Use less detergent for future wash loads. Detergents specifically designed for you High Efficiency washer produce fewer suds and will include the letters "HE" on the packaging.
Repeated spinning.	This is not a fault. The imbalance compensation system is attempting to balance the load through repeated spins.	Always load the drum with large and small items together.
The laundry was not spun.	Large items of clothing have become entangled and could not be distributed evenly in the drum. For reasons of safety the high-speed spin cycle was automatically suppressed.	Always load the drum with large and small items together.
Program duration extended.	This is not a fault. The suds detection feature has activated an additional rinsing cycle to reduce the amount of suds.	Add a more appropriate amount of detergent.
	This is not a fault. The imbalance compensation system is attempting to balance the load through repeated spins.	Always load the drum with large and small items together.

Fault	Possible cause	Action
Unsatisfactory washing result.	The degree of soiling was higher than estimated.	Select suitable program or Power wash as an additional option.
	Not enough detergent.	Add detergent according to the manufacturer's specifications.
Detergent residue on the laundry.	Some phosphate-free detergents contain water-insoluble residues that may appear as light spots on the laundry.	Brush off spots when laundry is dry.
Gray residue on the laundry.	Dirt accumulation from ointments, fats or oils.	Add the maximum amount of detergent and select the highest permissible temperature.
System shakes or shudders when passing from lower to higher speed spinning.	Drum system suspension can shift during speed up, this is not a failure.	Mix small and large laundry pieces in load to minimize this effect.

Fault displays

Text in display field	Possible cause	Action
"Water tap closed?"	Water taps not turned on.	Turn on water tap. Program continues.
	Supply hose kinked or trapped.	Eliminate the cause.
	Strainer in supply hose clogged.	Clean the water inlet strainers; see Page 27.
	Water pressure too low.	Eliminate the cause.
"Suds or blocked pump?"	Suds or pump is blocked.	Use less detergent for future wash loads. Detergents specifically designed for your High Efficiency washer produce fewer suds and will include the letters "HE" on the packaging. Clean the water drainage pipe and/or drain hose.
"Check Door!"	Door not closed properly.	Check whether laundry is trapped in door. Close the door.

If the fault cannot be eliminated with the aid of the above table, switch the appliance off, wait 5 seconds, switch the appliance on again, select and start the program.

If the fault continues, call customer service; see Page 32.

Customer Service

The washing machine requires no special care other than the care and cleaning noted previously. If you are having a problem with your washing machine, please refer to page 29 before calling for service.

If service becomes necessary, contact your dealer or installer or an authorized service center. Do not attempt to repair the appliance yourself. Any work performed by unauthorized personnel may void the warranty.

If you are having a problem with your washing machine and are not pleased with the service you have received:

- ❑ First, please contact your installer or the Authorized Service Contractor in your area and explain to them why you are not satisfied. This will usually correct the problem.
- ❑ If after working with your installer or service technician the problem still has not been resolved to your satisfaction, please let us know either by writing to us at:

BSH Home Appliances
5551 Mc Fadden Ave.
Huntington Beach, CA 92649

or calling us:
1-800-944-2904

If writing or calling, please provide the following information:

- Model Number
- Serial Number
- Date of Original Purchase
- Date Problem occurred
- Explanation of Problem

If writing, please also include a daytime telephone number and a copy of the sales invoice.

You will find the model number and serial number on the rating plate located on the housing and is visible with the door open.



STATEMENT OF LIMITED PRODUCT WARRANTY

What this Warranty covers & Who it Applies to:

The limited warranty provided by BSH Home Appliances ("BOSCH") in this Statement of limited product Warranty applies only to the Bosch Nexxt 800 Series washer ("Bosch") sold to you, the first using purchaser, provided that the Product was purchased: (1) for your normal, household (non-commercial) use, and has in fact at all times only been used for normal household purposes; (2) new at retail (not a display, "as is", or previously returned model), and not for resale, or commercial use; and (3) within the United States or Canada, and has at all times remained within the country of original purchase. The warranties stated herein apply only to the first purchaser of the Product and are not transferable.

i Please make sure to return your registration card: while not necessary to effectuate warranty coverage, it is the best way for Bosch to notify you in the unlikely event of a safety notice or product recall.

How Long the Warranty Lasts:

Bosch warrants that the Product is free from defects in materials and workmanship for a period of three hundred sixty-five (365) days from the date of purchase. The foregoing timeline begins to run upon the date of purchase, and shall not be stalled, tolled, extended, or suspended, for any reason whatsoever.

Repair/Replace as Your Exclusive Remedy:

During this warranty period, Bosch or one of its authorized service providers will repair your Product without charge to you (subject to certain limitations stated herein) if your Product proves to have been manufactured with a defect in materials or workmanship. If reasonable attempts to repair the Product have been made without success, then Bosch will replace your Product (upgrade models may be available to you, in Bosch's sole discretion, for an additional charge). All removed parts and components shall become the property of Bosch at its sole option. All replaced and/or repaired parts shall assume the identity of the original part for purposes of this warranty and this warranty shall not be extended with respect to such parts. Bosch's sole liability and responsibility hereunder is to repair manufacturer-defective Product only, using a

Bosch-authorized service provider during normal business hours.

For safety and property damage concerns, Bosch highly recommends that you do not attempt to repair the Product yourself, or use an un-authorized servicer; Bosch will have no responsibility or liability for repairs or work performed by a non-authorized servicer. If you choose to have someone other than an authorized service provider work on your Product, THIS WARRANTY WILL AUTOMATICALLY BECOME NULL AND VOID. Authorized service providers are those persons or companies that have been specially trained on Bosch products, and who possess, in Bosch's opinion, a superior reputation for customer service and technical ability (note that they are independent entities and are *not* agents, partners, affiliates or representatives of Bosch).

Notwithstanding the foregoing, Bosch will not incur any liability, or have responsibility, for the Product if it is located in a remote area (more than 100 miles from an authorized service provider) or is reasonably inaccessible, hazardous, threatening, or treacherous locale, surroundings, or environment; in any such event, if you request, Bosch would still pay for labor and parts and ship the parts to the nearest service provider, but you would still be fully liable and responsible for any travel time or other special charges by the service company, assuming they agree to make the service call.

Out of Warranty Product: Bosch is under no obligation, at law or otherwise, to provide you with any concessions, including repairs, pro-rates, or Product replacement, once this warranty has expired.

Warranty Exclusions: The warranty coverage described herein excludes all defects or damage that are not the direct fault of Bosch, including without limitation, one or more of the following: (1) use of the Product in anything other than its normal, customary and intended manner (including without limitation, any form of commercial use, use or storage of an indoor product outdoors, use of the Product in conjunction with air or water-going vessels); (2) any part's willful misconduct, negligence, misuse, abuse, accidents, neglect, improper operation, failure to maintain, improper or negligent installation, tampering, failure to follow operating instructions, mishandling, unauthorized service (including self-performed "fixing" or exploration of the appliance's internal

workings); (3) adjustment, alteration or modification of any kind; (4) a failure to comply with any applicable state, local, city, or county electrical, plumbing and/or building codes, regulations, or laws, including failure to install the product in strict conformity with local fire and building codes and regulations; (5) ordinary wear and tear, spills of food, liquid, grease accumulations, or other substances that accumulate on, in, or around the product; and (6) any external, elemental and/or environmental forces and factors, including without limitation, rain, wind, sand, floods, fires, mud slides, freezing temperatures, excessive moisture or extended exposure to humidity, lightning, power surges, structural failures surrounding the appliance, and acts of God. In no event shall Bosch have any liability or responsibility whatsoever for damage to surrounding property, including cabinetry, floors, ceilings and other structures or objects around the Product. Also excluded from this warranty are scratches, nicks, minor dents, and cosmetic damages on external surfaces and exposed parts; Products on which the serial numbers have been altered, defaced, or removed; service visits to teach you how to use the Product, or visits where there is nothing wrong with the Product; correction of installation problems (you are solely responsible for any structure and setting for the Product, including all electrical, plumbing or other connecting facilities, for proper foundation/flooring, and for any alterations including without limitation cabinetry, walls, floors, shelving, etc.); and resetting of breakers or fuses. **TO THE EXTENT ALLOWED BY LAW, THIS WARRANTY SETS OUT YOUR EXCLUSIVE REMEDIES WITH RESPECT TO PRODUCT, WHETHER THE CLAIM ARISES IN CONTRACT OR TORT (INCLUDING STRICT LIABILITY, OR NEGLIGENCE OR OTHERWISE. THIS WARRANTY IS IN LIEU OF ALL OTHER WARRANTIES, WHETHER EXPRESS OR IMPLIED. ANY WARRANTY IMPLIED BY LAW, WHETHER FOR MERCHANTABILITY OR FITNESS FOR A PARTICULAR PURPOSE, OR OTHERWISE, SHALL BE EFFECTIVE ONLY FOR THE PERIOD THAT THIS EXPRESS LIMITED WARRANTY IS EFFECTIVE. IN NO EVENT WILL THE MANUFACTURER BE LIABLE FOR CONSEQUENTIAL, SPECIAL, INCIDENTAL, INDIRECT, "BUSINESS LOSS", AND/OR PUNITIVE DAMAGES, LOSSES, OR**

EXPENSES, INCLUDING WITHOUT LIMITATION TIME AWAY FROM WORK, HOTELS AND/OR RESTAURANT MEALS, REMODELLING EXPENSES IN EXCESS OF DIRECT DAMAGES WHICH ARE DEFINITELY CAUSED EXCLUSIVELY BY BOSCH, OR OTHERWISE. SOME STATES DO NOT ALLOW THE EXCLUSION OR LIMITAITON OF INCIDENTAL OR CONSEQUENTIAL DAMAGES, AND SOME STATES DO NOT ALLOW LIMITATIONS ON HOW LONG AN IMPLIED WARRANTY LASTS, SO THE ABOVE LIMITAITONS MAY NOT APPLY TO YOU. THIS WARRANTY GIVES YOU SPECIFIC LEGAL RIGHTS AND YOU MAY ALSO HAVE OTHER RIGHTS WHICH VARY FROM STATE TO STATE. No attempt to alter, modify or amend this warranty shall be effective unless authorized in writing by an officer of BSH.

How to Obtain Warranty Service: To obtain warranty service for your Product, you should contact the nearest Bosch authorized service center.

BSH Home Appliances –
5551 McFadden Avenue
Huntington Beach,
CA 92649
1-800-944-2904

STATEMENT OF WARRANTIES FOR BOSCH CLOTHES WASHERS

The warranties provided by BSH Home Appliances ("Bosch") in this Statement of Warranties apply only to Bosch

Clothes washers sold to the first using purchaser by Bosch or its authorized dealers, retailers or service centers in

the United States or Canada. The Warranties provided herein are not transferable.

LENGTH OF WARRANTY	SCOPE OF WARRANTY
1 Year Full Limited Warranty From Date of Installation*	Bosch will repair or replace, free of charge, any component part that proves defective under conditions of normal home use, labor and shipping costs included. Warranty repair service must be performed by an authorized Bosch Service Center (excluded cosmetic parts).
2 Year Limited Warranty From Date of Installation*	Bosch will provide replacement parts, free of charge, for any component part that proves defective under conditions of normal home use, shipping costs included, labor charges excluded.
2 Year Limited Warranty on Electronics From Date of Installation*	Bosch will repair or replace, free of charge, any microprocessor or printed circuit board that proves defective under conditions of normal home use during the first two years from the date of original installation, labor charges excluded.
2 Year Limited Warranty on Motor From Date of Installation*	Bosch will repair or replace, free of charge, any motor or component part of the motor that proves defective under conditions of normal home use during the first two years from the date of original installation, labor charges excluded.
* Date of installation shall refer to the earlier date the clothes washer is installed or ten business days after the delivery date.	

Exclusions

This warranty does not cover service calls or repairs to correct the installation of the clothes washer, to provide instructions on the use of your clothes washer, to replace house fuses or correct plumbing or the electric wiring in your home or to repair any clothes washer that is used in a manner other than what is normal and customary for home use.

In addition, the warranties provided in this Statement exclude any defects or damage arising from accident, alteration, misuse, abuse, improper installation, unauthorized service work, external forces beyond Bosch's control, such as fire, flood, and other acts of God, or installation not in accordance with local electrical and plumbing codes. Labor charges incurred in the repair or replacement of any clothes washer after a period of one year from date of installation shall not be covered by this warranty.

Any and all replaced and/or repaired parts shall assume the identity of the original for purposes of the applicable warranty period.

TO THE EXTENT PERMITTED BY LAW, THIS WARRANTY IS IN LIEU OF ALL OTHER EXPRESSED AND IMPLIED WARRANTIES, INCLUDING THE IMPLIED WARRANTIES OF MERCHANTABILITY AND FITNESS FOR A PARTICULAR PURPOSE. BOSCH DOES NOT ASSUME ANY RESPONSIBILITY FOR INCIDENTAL OR CONSEQUENTIAL DAMAGES.

TO OBTAIN WARRANTY SERVICE. CONTACT THE NEAREST BOSCH AUTHORIZED SERVICE CENTER OR CALL 1-800-944-2904 OR WRITE TO: BSH HOME APPLIANCES ATTN. SERVICE 5551 MC FADDEN AVE. HUNTINGTON BEACH, CA 92649 BE SURE TO PROVIDE YOUR CLOTHES WASHER MODELNUMBER, SERIAL NUMBER, PURCHASE DATE, THE SELLER'S NAME AND ADDRESS, DATE PROBLEM OCCURRED, EXPLANATION OF PROBLEM, DAYTIME TELEPHONE NUMBER WHERE YOU CAN BE REACHED AND A COPY OF THE SALES INVOICE.