

# Stainless Steel & Glass Island Extractor

## LAM2600



**Instillation & User Instructions**

# LAMONA

Exclusive to Howdens Joinery Co.

# Contents

<b>Environmental note</b>	<b>3</b>
<b>Important Safety &amp; Technical Information</b>	<b>4</b>
<b>Product Information</b>	<b>5</b>
<b>Methods of Extraction</b>	<b>6</b>
<b>Installation</b>	<b>7</b>
<b>Electrical Connections</b>	<b>11</b>
<b>Operating Your Extractor</b>	<b>12</b>
The Grease Filters	
The Carbon filters	
<b>Maintenance</b>	<b>13</b>
General Cleaning	
Replacing the halogen Lamps	
<b>Troubleshooting</b>	<b>14</b>
<b>Your Guarantee</b>	<b>15</b>
Product guarantee details	
What to do if you need to report a problem	

# Environmental note



This appliance is marked according to the European directive 2002/96/EC on Waste Electrical and Electronic Equipment (WEEE). By ensuring this product is disposed of correctly, you will help prevent potential negative consequences for the environment and human health, which could otherwise be by inappropriate waste handling of this product.

The symbol on the product, or on the documents accompanying the product, indicates that this appliance may not be treated as household waste. Instead it shall be handed over to the applicable collection point for recycling of electrical and electronic equipment.

Disposal must be carried out in accordance with local environmental regulations for waste disposal.

For more detailed information about treatment, recovery and recycling of this product, please contact your local city office, your household waste disposal service or the shop where you purchased the product.

- The packaging materials that Lamona uses are environmentally friendly and can be recycled
- Please discard all packaging material with due regard for the environment.

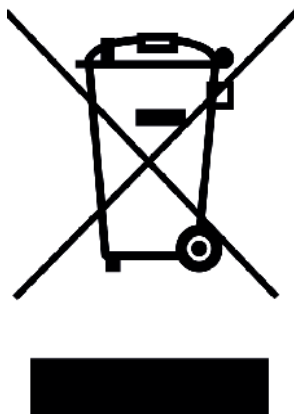

# Important safety information



**Your safety is of the utmost importance to Lamona. Please make sure that you read this instruction booklet before attempting to install or use the appliance. If you are unsure of any of the information contained in this booklet, please contact the Lamona Advice Line.**

**Keep this Book in a handy place for reference; it contains important details on the safe and proper use of your appliance. Should you sell the extractor please remember to pass on the instruction book to the new owner.**

## Technical Information

The extractor is designed to give you the option to extract air by ducting to the outside and away (via an exterior wall), or to re-circulate through charcoal filters to minimise odours, steam and condensation. The choice is yours to decide at installation, and both systems are explained in the booklet.

### Data

Power Supply: 230/240v ~ 50Hz

Rating: 470 W

Fuse Rating: 3 A

4 bulbs Halogen Lamps 50 W each

Our policy is one of continual improvement in design and development, therefore strict accuracy of illustrations and descriptions cannot be guaranteed.

# Product Information

On opening your box you will find the extractor hood, glass canopy, a telescopic decorative outer chimney, adjustable inner chimney assembly, a ducting connector, and a bag of fixings and screws.

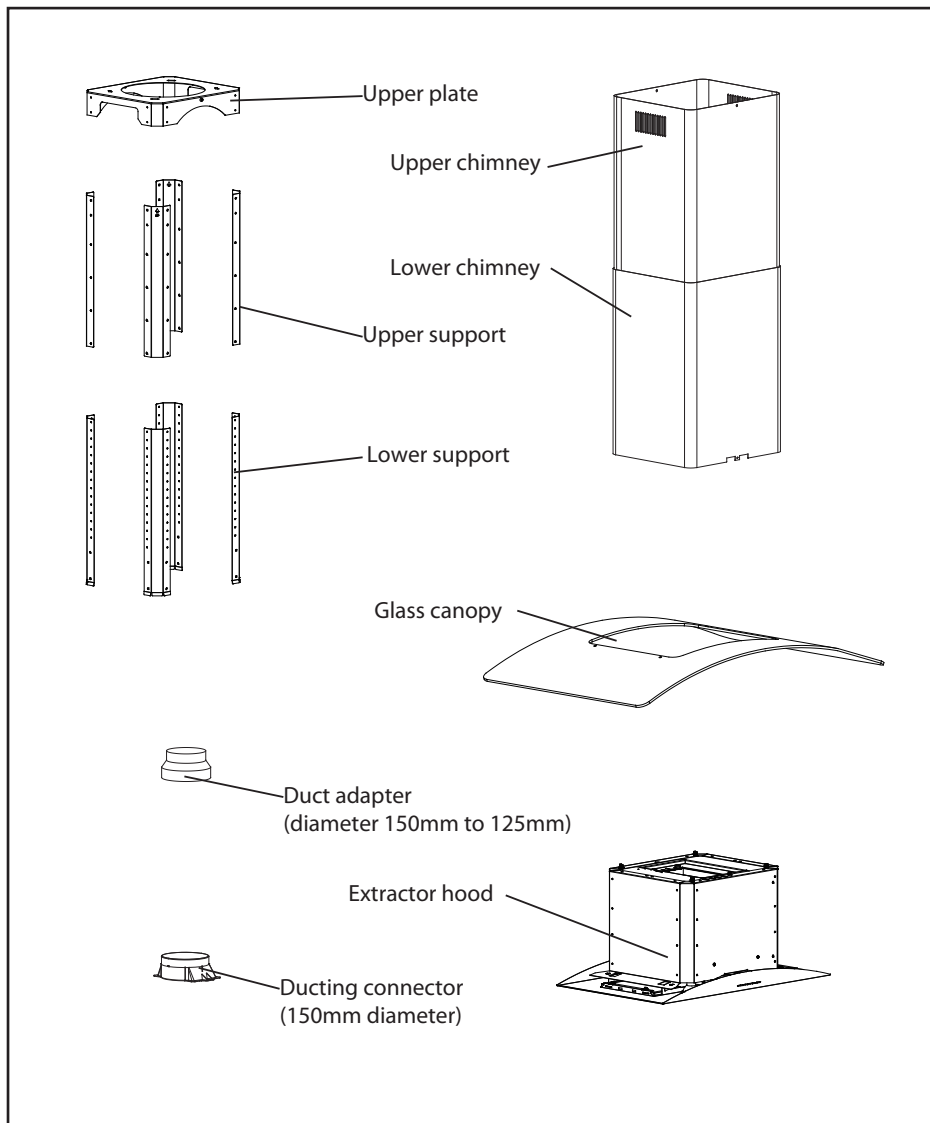

# Methods of Extraction

The very best method of cleaning the kitchen of unwanted odours is by connecting the appliance to an exhaust duct and venting to the outside atmosphere via the ceiling to an exterior wall. (Suitable ducting kits may be purchased from the store where you bought your extractor.) You do not need a charcoal filter when using the ducting mode.

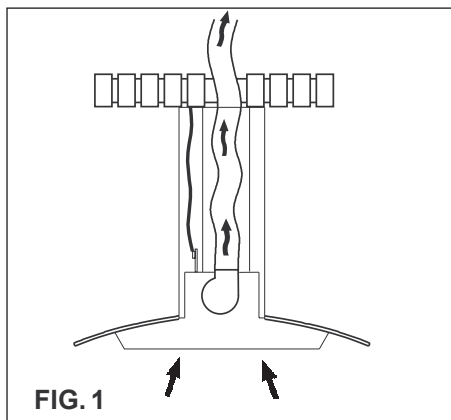

**FIG. 1**

DUCTING MODE  
(no charcoal filter required)

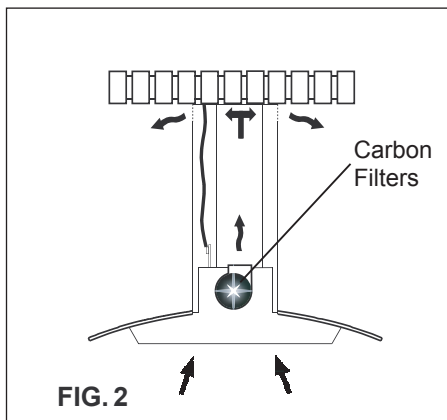

**FIG. 2**

RECIRCULATING MODE  
(charcoal filter required)

**REMEMBER: BEFORE DRILLING OR CHISELLING THE CEILING OR WALL, CHECK FOR PIPES AND POWER CABLES.**

1. Ensure the ducting tube is kept as short as possible and with the minimum of bends to permit the smoothest airflow. (Maximum length 3 metres.)
2. Ducted air must not be discharged into a flue, which is used for exhausting fumes from appliances supplied with energy other than electricity.
3. Ensure the requirements of the local authorities are adhered to concerning the discharge of exhaust air.
4. Ensure adequate room ventilation is provided when the extractor is used in the same room as appliances supplied with energy other than electricity.
5. Never duct into a hot air flow such as a central heating duct.

**WE STRONGLY ADVISE THAT ALL EXTERIOR OUTLETS BE FITTED WITH A NON-RETURN VALVE OR LOUVRED SLATTING**

# Installation

**This instruction must be strictly adhered to. Failure to comply could result in overheating and serious damage to your appliance.**

It is recommended that the installation is carried out by at least two people.

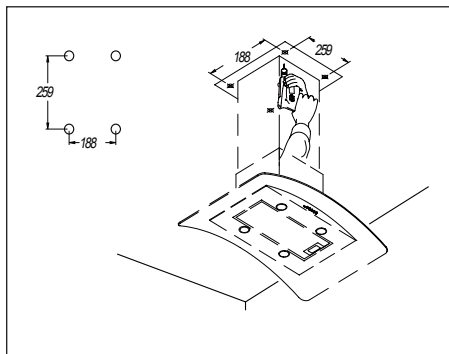

- 1.** Mark and drill four holes using to the dimensions shown and install the ducting facilities (if ducting the extractor out) in the ceiling. Ensure that the extractor is secured into joists (it may be necessary to add wooden struts between the joists).

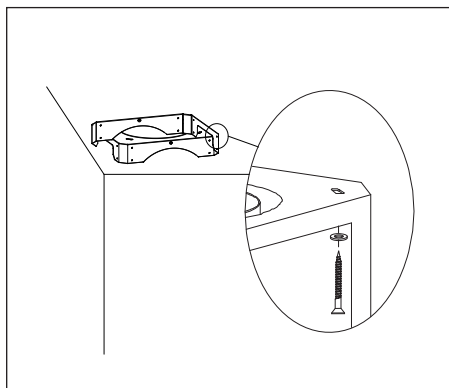

- 2.** Mount the upper plate onto the ceiling using 4 suitable screws and washers

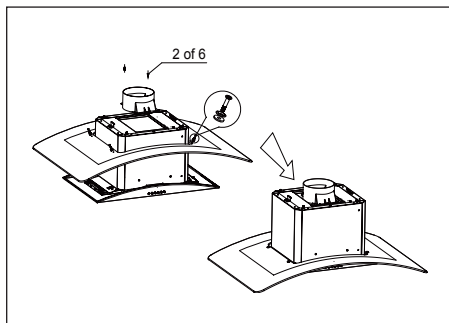

- 3.** Secure the ducting connector and glass canopy to the extractor body

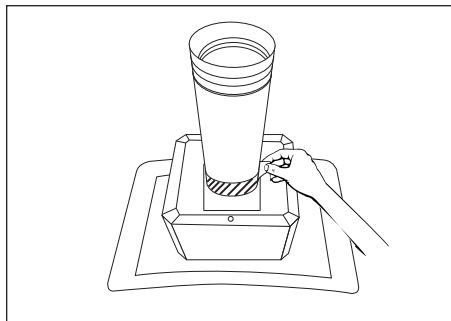

- 4.** Place the exhaust duct onto the connector and secure it with duct tape or tie wrap

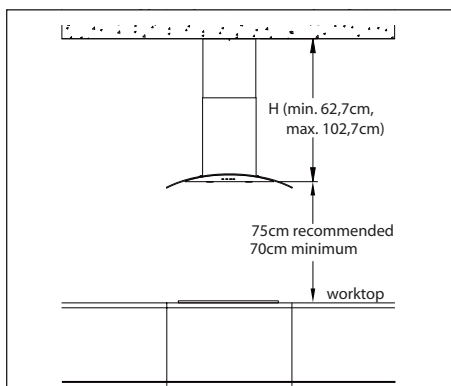

- 5.** The recommended clearance Between the extractor and the work top is 750mm. The minimum allowable clearance is 700mm

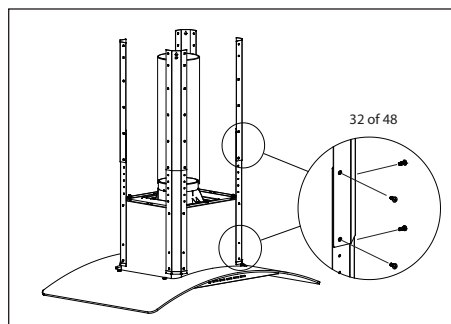

- 6.** Fix the lower and upper supports to the extractor hood at the required length with 32 screws



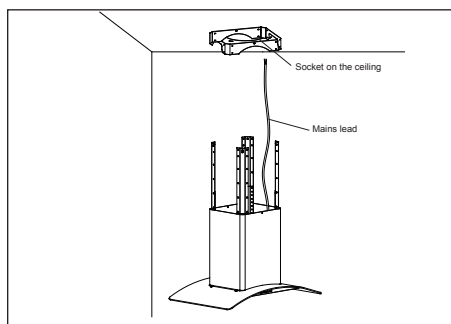
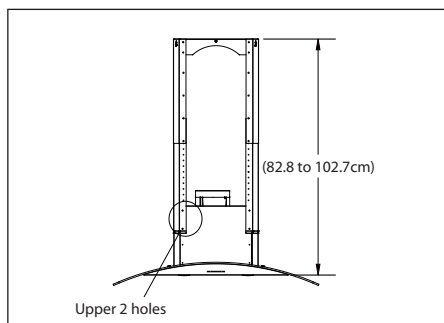
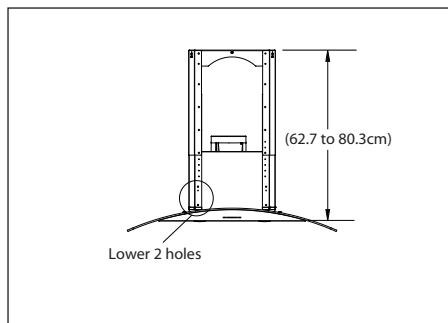

**7.** Place the inner and outer chimneys on the extractor hood, and make the electrical connection.

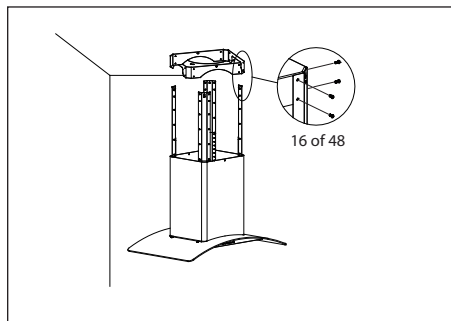

**8.** Fix the extractor assembly to the upper plate with 16 screws.

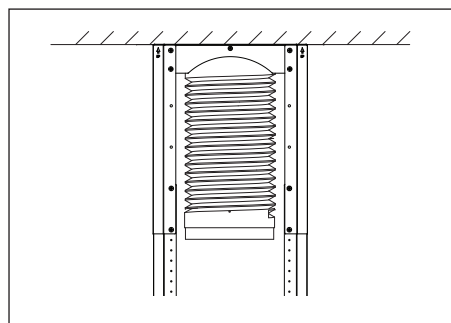

**9.** Connect the duct to the outlet on the ceiling if ducting out, or to the filter if recirculating.

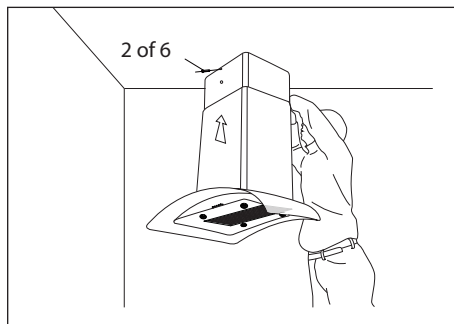

**10.** Slide up the inner chimney and fix it to the upper plate with 2 screws.

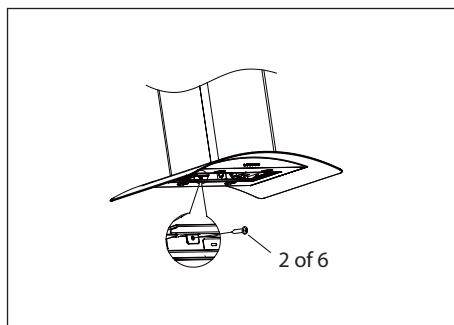

**11.** Finally fix the outer chimney to the extractor hood with 2 screws.

# Electrical Connections

**IMPORTANT: ENSURE THAT THE ELECTRICITY SUPPLY IS SWITCHED OFF BEFORE CONNECTING.**

Your appliance must be connected to fixed wiring via the use of a double pole switched fused spur outlet with at least 3mm contact separation, with a pilot lamp.

The isolation switch must be accessible after installation.

(See technical data for fuse rating).

We strongly recommend the appliance is connected by a qualified electrician who is a member of the N.I.C.E.I.C. or Gas Safe Register who will comply with the I.E.E and any local regulations.

## NOTE:

The terminology -DOUBLE POLE+ means that both the live and neutral supplies are switched and disconnected at the same time.

The terminations labelled SUPPLY are for the connection for the internal house wiring and the terminations labelled LOAD are for the connection for the appliance.

## IMPORTANT

The wires in this mains lead are coloured in accordance with the following code:-

Blue ..... Neutral  
Brown ..... Live

As the colours of the wires in the mains lead of this appliance may not correspond with the coloured markings identifying the terminals in your spur box, proceed as follows;

The wire which is coloured blue must be connected to the terminal which is marked with the letter 'N' or coloured black. The wire which is coloured brown must be connected to the terminal which is marked with the letter 'L' or coloured red.

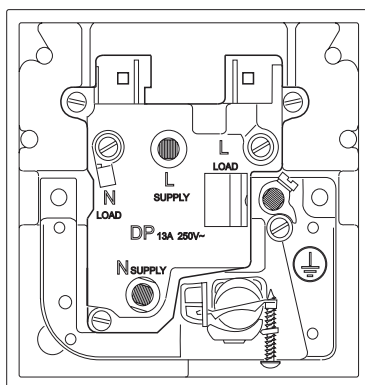
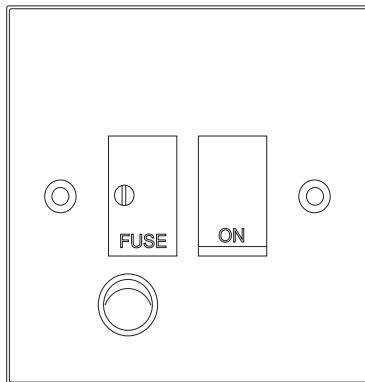

## TECHNICAL DATA FUSE RATING

# 5AMP

# Operating Your Extractor

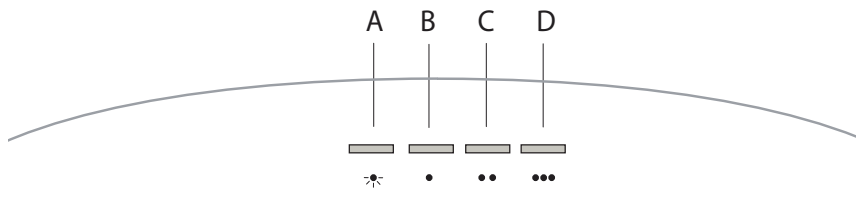

A) Light switch.

B) Selects motor speed 1.

C) Selects motor speed 2.

D) Selects motor speed 3.

**WARNING: NEVER HAVE A LIGHTED FLAME UNDER THE EXTRACTOR HOOD.**

## The Grease Filters

The grease filter is of a metallic material and should be washed using a neutral detergent or in a dishwasher.

### REMOVAL OF GREASE FILTERS:

1 Press latch towards side of extractor

2 Remove filter.

**IMPORTANT:** You should never attempt to use the extractor without the grease filter, since grease build-up could prevent the motor working properly. If the filter is not cleaned regularly the risk of fire will be increased.

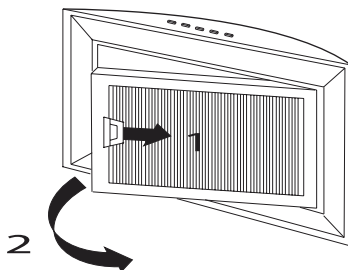

## The Carbon Filters

Carbon filters have a limited life. We advise you to change them when there is a noticeable drop in performance. The intervals between changing the filter will depend entirely upon the amount of cooking you do, but on average they will last about 6 months.

To gain access to the carbon filters first of all, remove the grease filters as above. Remove the old filters and reposition new charcoal filters (HJA2900 - pack of 2).

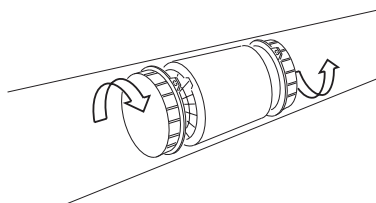

# Maintenance

Before cleaning or attempting any type of maintenance, always make sure that the electric supply is disconnected.

To avoid the possibility of fire, adhere strictly to all of the recommendations included in this booklet, paying particular attention to the grease filters to ensure grease deposits do not build up.

THE MANUFACTURER DECLINES ALL LIABILITY IN CASES WHERE THE INSTRUCTIONS FOR THE APPROPRIATE INSTALLATION, MAINTENANCE AND USE OF THE EXTRACTOR HOOD ARE NOT OBSERVED.

If the power supply is cut or damaged in any way, disconnect the extractor from the electricity supply and call the service number on the rear cover of this booklet.

## General Cleaning

Wipe the external surfaces of the appliance regularly using warm water and a mild detergent. NEVER use abrasive cleaners.

## Replacing the Halogen Lamps

Ensure that the power is switched off.

Unscrew to remove the lamp and replace it with a new lamp of the same type and wattage. Remove grease filters to make it easier.

IMPORTANT WARNING:

The replacement lamps must have aluminium reflector, never use dichroic lamps, to avoid unnecessary overheating on the lamp holders.

NOTE: LAMP REPLACEMENT IS NOT COVERED BY YOUR GUARANTEE

# Trouble Shooting

Before you assume the worst, check this simple fault-finding guide to get to the root of the problem:

1. Halogen Lamps fail to operate

A replacement is probably necessary, but first check that the lamp is correctly fitted into its holder. Remember that the light bulbs are not covered by our guarantee. Remember to disconnect the mains electricity supply before replacing the lamps.

2. Motor is on but fan does not seem to be as efficient as usual

Check the grease filter. If it has not been cleaned recently, it might be clogged with grease. If this filter is relatively clean, check carbon filters (if fitted). If they have not been replaced for more than six months, remove and insert new ones. As time goes by, accumulated grease tends to stifle the carbon filters in just the same way as the grease filter, thereby reducing the efficiency of both the fan and the filter itself.

3. Works normally but cooking smells linger

If you're using the unit in recirculating mode, change the charcoal filter. It may require replacement.

4. Appliance does not work at all

Check your extractor is switched on at the mains. Next, check there is power to your home by switching on adjacent lights etc.

5. Still not working? Call the service agent

If, having consulted the above diagnostic chart you are still unable to remedy the situation, please call the service number on the rear cover of this manual.

# Your Guarantee

## Product Guarantee Details (UK only)

YOUR APPLIANCE HAS THE BENEFIT OF A COMPREHENSIVE MANUFACTURER'S GUARANTEE WHICH COVERS THE COST OF BREAKDOWN REPAIRS. (DETAILS OF WHICH ARE SHOWN ON YOUR PROOF OF PURCHASE DOCUMENT).

- Any claim during the period of the guarantee (MUST BE ACCOMPANIED BY THE PROOF OF PURCHASE)
- The product must be correctly installed and operated in accordance with the manufacturer's instructions and used for normal domestic purposes.
- This guarantee does not cover accidental damage, misuse or alterations which are likely to affect the product.
- The guarantee is invalid if the product is tampered with, or repaired by any unauthorised person.

(The guarantee in no way affects your statutory or legal rights)

## What to do if you need to report a problem-

Please ensure you have ready:

- The product's model & serial numbers
- Howdens Proof of Purchase document
- Your full contact details.

**Call the Lamona Service Line on 0845 00 60 006**