

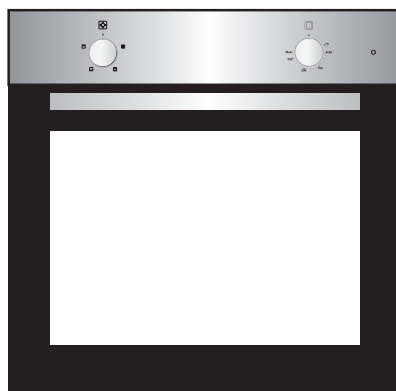

# **Built-in Oven**

## **LAM 3200**

### **Installation & User's Instructions**





# using this manual

Thank you for choosing a Lamona built-in oven

This user manual will help you to use the product quickly and safely. Please read it carefully and keep it somewhere safe for future reference.

**The following symbols are used in the text of this Owner's Manual:**



**WARNING or CAUTION**



**Important**



**Note**

## safety instructions

We recommend that the oven is installed by a qualified electrician in accordance with all local regulations.

### ELECTRICAL SAFETY

If the oven has been damaged in transport, do not connect it.

- This appliance must be connected to the mains power supply only by a qualified electrician.
- In the event of a fault or damage to the appliance, do not attempt to operate it.
- Repairs should be performed by an authorised service agent only. Improper repair may result in danger to you and others. If your oven needs repair, contact the service help-line.
- If the supply cord is damaged, it must be replaced by a suitably qualified person or an authorised service agent.
- Electrical leads and cables should not be allowed to touch the oven.
- The oven should be connected to the mains power supply by means of an approved circuit breaker or fuse.
- The power supply of the appliance should be turned off if it is being cleaned or repaired.
- This appliance is not intended for use by persons (including children) with reduced physical, sensory or mental capabilities, or lack of experience and knowledge, unless they have been given supervision or instruction concerning use of the appliance by a person responsible for their safety.
- We recommend that the isolation power switch is easily accessible after installation.



**WARNING:** Accessible parts may become hot during use. To avoid burns young children should be kept away.



**WARNING:** The appliance and its accessible parts may become hot during use. Care should be taken to avoid touching heating elements inside the oven. Children be kept away unless continuously supervised.



**WARNING:** Ensure that the appliance is switched off before replacing the lamp to avoid the possibility of electric shock.





## SAFETY DURING OPERATION

- This oven has been designed only for the domestic cooking of household foods.
- During use, the interior surfaces may become hot enough to cause burns. Do not touch heating elements or interior surfaces of the oven until they have had time to cool.
- Never store flammable materials in the oven.
- The oven surfaces may remain hot for sometime after turning the oven off. Especially after a prolonged period of cooking.
- When cooking, take care when opening the oven door as hot air and steam can escape rapidly.
- When cooking dishes that contain alcohol, the alcohol may evaporate due to the high temperatures and the vapour can catch fire if it comes into contact with a hot part of the oven.
- For your safety, do not use high-pressure water cleaners or steam jet cleaners.
- Children should be kept at a safe distance when the oven is in use.
- Never pour water onto the base of the oven.
- The oven door must be closed during cooking.
- Do not line the oven bottom or grill pan with aluminium foil. Do not place baking trays or tins on the oven bottom as this may result in damage to the enamel surfaces and poor cooking results.
- Do not rest anything on the open oven door.
- Do not use harsh abrasive cleaners or sharp metal scrapers to clean the oven or door glass, as they can scratch the surface and may result in shattering of the glass



**WARNING:** Do not turn the oven off at the mains immediately after cooking as the internal cooling fan needs to operate.



**WARNING:** The surface of the oven door gets hot when it is in use. Do not touch the hot surface of the door until it has had time to cool.

## DISPOSAL INSTRUCTIONS

### Disposing of the packaging material

- The material used to package this appliance is recyclable.
- Dispose of the packaging materials in the appropriate container at your local waste disposal facility.

### Disposing of old appliances



**WARNING:** Before disposing of old appliances, make them inoperable so that they cannot be a source of danger.

**To do this, disconnect the appliance from the mains supply and remove the mains lead.** To protect the environment, it is important that old appliances are disposed of in the correct manner.

- The appliance must not be disposed of with household rubbish.
- You can obtain information about collection dates and public refuse disposal sites from your local refuse department or council.



# installation

## ⚠ Safety instructions for the installation

This oven may be installed only by a qualified electrician. The installer is responsible for connecting the appliance to the mains and observing the relevant safety regulations.

## Technical specifications

Input voltage / frequency	230 V ~ 50 Hz
Volume (usable capacity)	65 ℓ
Output rating	max. 2400 W
Net weight	approx. 30 kg
Weight with packaging	approx. 35 kg
Housing (W x H x D)	595 x 595 x 566 mm
Oven interior (W x H x D)	440 x 365 x 405 mm

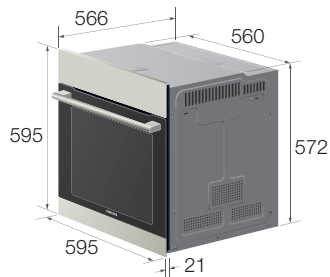

## Power connection

A multi-pole isolator switch (with at least 3 mm contact spacing) must be provided in order to satisfy safety regulations. The power cable (H05 RR-F or H05 VV-F, min. 1.5 m, 1.5 ~ 2.5 mm<sup>2</sup>) must be of sufficient length to be connected to the oven, even if the oven stands on the floor in front of its built-in cabinet. Open the rear connection cover of the oven with a screwdriver and loosen the screws of the cable clamp before you connect the wires to the relevant connection terminals. The oven is earthed via the (⏏)-terminal.

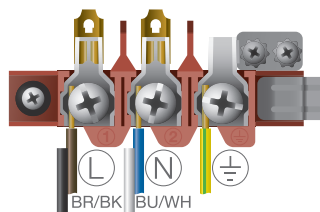

(The manufacturer accepts no responsibility for faults or accidents arising from a defective earth connection)

Please ensure that the power cable is not trapped between the oven and units or wall when pushing back into position. Do not route cable over any potentially hot surfaces.

## Installation in the cabinet

This is a built-in oven, which needs to be installed into an upper or lower cabinet.

- Observe minimum distances.
- Fix oven on both sides using screws

After installation, remove the vinyl protective film from the door to the appliance and the protective film from the interior surfaces of the oven.

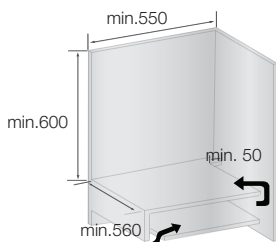

Air flow

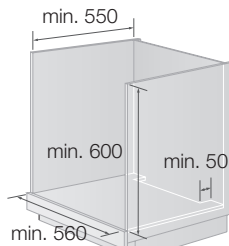

Lower Cabinet

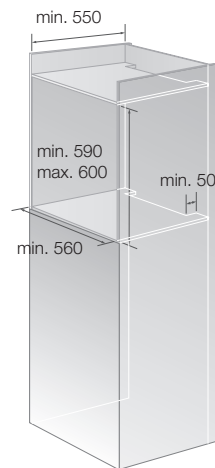

Upper Cabinet





# parts and features

## OVEN CONTROLS

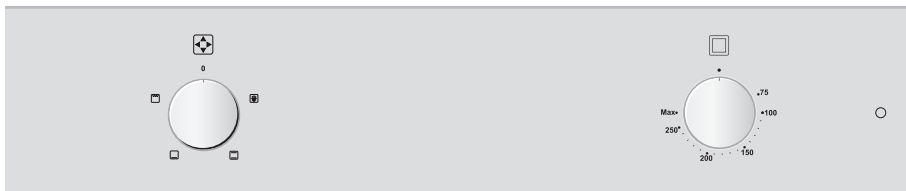

## ACCESSORY



**CAUTION:** Be sure to insert the grill pan correctly into the side racks. leave at least 2cm clearance from the bottom of the oven, otherwise the enamel surface could be damaged.



**WARNING:** Be very careful removing meals and/or accessories out of the oven. Hot meals, accessories and surfaces can burn you!



### Grill pan, grid & shelf

Shelf width : 461 mm  
Grid width : 422 mm  
Grill pan width : 460 mm



# oven use

## USING THE COOKING MODE

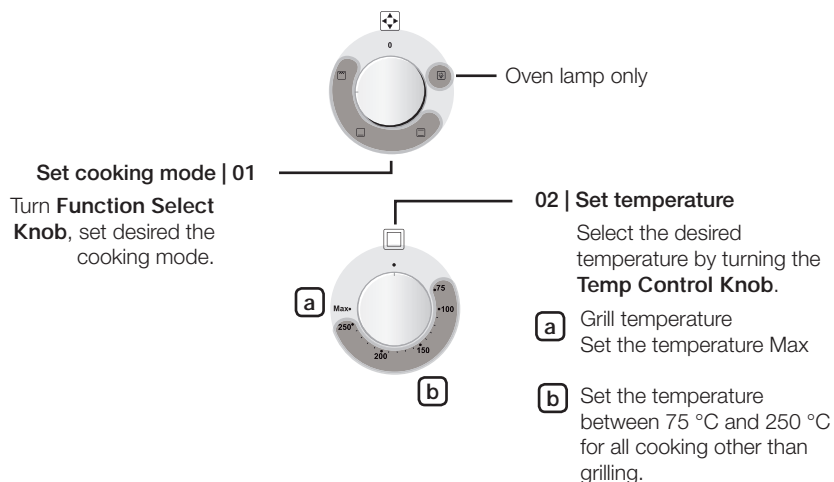

## Oven functions



### Conventional

Heat is emitted from the upper and lower heating elements. This function should be used for standard baking and roasting.  
Suggested temperature: 200°C



### Bottom Heat

Only bottom heat is on. Is particularly suitable for dishes, such as pizza, which are often cooked with heat from below.  
Suggested temperature: 190°C



### Large Grill

Heat is emitted from the large area grill. This function should be used for toasting and grilling meat.  
Suggested temperature: Max





# test dishes

According to standard EN 60350 and DIN44547

## Baking

The recommendations for baking refer to preheated oven.

Type of Food	Dish & Notes	Shelf level	Cooking Mode	Temp. (°C)	Cooking time (min.)
Shortbread	Baking tray on shelf	3	Conventional	140-160	25-35
Small Cakes	Baking tray on shelf	3	Conventional	150-170	25-35
Fatless Sponge Cake	Springform cake tin on shelf (ø 26 cm)	2	Conventional	165-185	25-35
Apple Pie	Shelf + 2 Springform cake tins * (ø 20 cm)	1 Placed diagonally	Conventional	170-190	70-90

\* Two cakes are arranged on the shelf at the back left and at the front right.

## Grilling

Use this function with the maximum temperature setting of Max.

Preheat the empty oven for 5 minutes using Large Grill function.

Type of Food	Dish & Notes	Shelf level	Cooking Mode	Temp. (°C)	Cooking time (min.)
White Bread Toast	Grill pan & grid	5	Large Grill	Max	1st: 1-2 2nd: 1-1½
Beef Burgers (12ea)	Grill pan & grid	4	Large Grill	Max	1st: 12-16 2nd: 8-13



# cleaning and care

## CLEANING



Make sure the oven and any accessory is cool before cleaning. We recommend that you clean the oven after each use to prevent the build-up of burnt-on food and the associated smells produced.

### Oven Interior

- For cleaning the interior of the oven, use a clean cloth and a mild cleaning agent or warm soapy water.
- Great care should be taken if cleaning the door seal.
- Do not use scouring pads or abrasive cleaning sponges.
- To remove stubborn soil, use a dedicated branded oven cleaner.

### Oven Exterior

- For cleaning the exterior of the oven, use a clean cloth and a mild cleaning agent or warm soapy water.
- Dry with kitchen roll or a dry towel.
- Do not use scourers, caustic cleaners or abrasive products.

### Stainless steel oven fronts

- Do not use steel wool, scouring pads or other abrasives. They may damage the finish.

### Aluminium oven fronts

- Wipe the surface gently with a soft clean cloth or microfibre cloth and a mild window cleaning detergent.

### Accessory

- Wash the grill pan and grid after every use and dry it with a kitchen towel. If necessary, leave in warm soapy water for about 30 minutes for easier cleaning.

## DOOR REMOVAL

For normal use, the oven door must not be removed but if removal is necessary, for example, for cleaning purposes, follow these instructions.

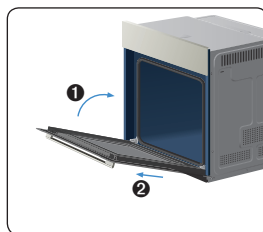
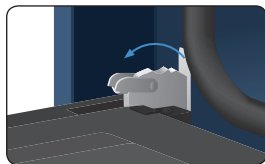

**CAUTION:** The oven door is heavy.

1. Ensure oven is cold. Open the door and flip open the clips at both hinges completely.
2. Close the door to approximately 70°. With both hands, grip the sides of the door centrally and pull/lift the door until the door and hinges come away from the oven.







## DOOR GLASS REMOVAL

The oven door can be removed for cleaning.

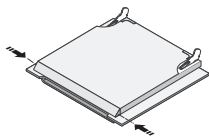

1. Press the buttons on the left and right sides of the the door together.

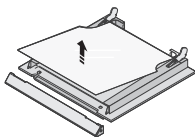

2. Detach the covering and remove glass 1 from the door.

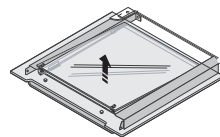

3. Lift glass 2 and Clean the sheets with warm water or washing-up liquid and polish dry them with a soft clean cloth.

## BULB REPLACEMENT



Danger of electric shock!  
Before replacing the oven bulb:

- Switch oven Off and ensure oven is cold.
- Disconnect the oven from the mains.
- Protect the oven light bulb and the glass cap by laying a cloth on the bottom of the oven compartment.

### Lamp removal

1. Remove cap by turning anticlockwise and remove the metal ring, and the sheet ring. Replace the bulb with a 25 watt, 230 V, 300 °C heat-resistant oven light bulb.
2. Clean the glass cap, the metal ring and the sheet ring if necessary.
3. Fit the metal and the sheet ring to the glass cap.
4. Locate glass cap into hole and turn it clockwise to secure.

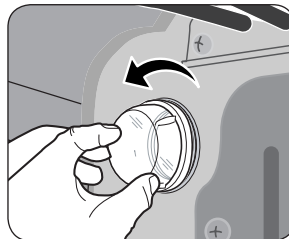



# guarantee & service

## TROUBLESHOOTING

PROBLEM	SOLUTION
What should I do if the oven doesn't heat up?	<ul style="list-style-type: none"><li>• The oven may not be switched on. Switch the oven on.</li><li>• Check to see if the required settings have been applied.</li><li>• A household fuse may have blown or a circuit breaker may have tripped. Replace the fuses or reset the circuit. If this happens repeatedly, call a qualified electrician.</li></ul>
What should I do if, even though the oven function and temperature have been set, the oven does not heat up?	<ul style="list-style-type: none"><li>• There may be problems with the internal electrical connections. Call the help-line.</li></ul>
What should I do if the oven light doesn't illuminate?	<ul style="list-style-type: none"><li>• The oven light may have failed. Replace the oven light bulb (see section "Bulb replacement").</li></ul>

English



### **Correct Disposal of This Product** **(Waste Electrical & Electronic Equipment)**

*(Applicable in the European Union and other European countries with separate collection systems)*

This marking on the product, accessories or literature indicates that the product and its electronic accessories should not be disposed of with other household waste at the end of their working life. To prevent possible harm to the environment or human health from uncontrolled waste disposal, please separate these items from other types of waste and recycle them responsibly to promote the sustainable reuse of material resources. Household users should contact either the retailer where they purchased this product, or their local government of residence, for details of where and how they can take these items for environmentally safe recycling. Business users should contact their supplier and check the terms and conditions of the purchase contract. This product and its electronic accessories should not be mixed with other commercial wastes for disposal.





# product guarantee details (uk only)

Details of your guarantee are shown on your Howdens Proof of Purchase Document.

## GUARANTEE CONDITIONS

- (a) Any claim during the period of the guarantee **MUST BE ACCOMPANIED WITH** your Howdens Proof of Purchase Document.
- (b) The unit must be correctly installed and operated in accordance with the manufacturer's instructions and used for normal domestic purposes.
- (c) The guarantee does not cover accidental damage, misuse or alterations which are likely to affect the units.
- (d) The guarantee is invalid if the units is tampered with, or repaired by any unauthorised person.
- (e) The guarantee in no way affects your statutory rights.
- (f) U.K only.

## PROCEDURE IF REPORTING A FAULT

- 1. Give full name, address including post code, home telephone number and business telephone number if appropriate.
- 2. Quote sales receipt number, make and model number of faulty appliance.
- 3. Give a summary of the problem.

Model No:	
Serial No:	





This manual is made with 100% recycled paper.

Code No.: DG68-00391B

